



## Council Agenda Item

Budget Account Code:	Meeting Date: April 21, 2015
Budgeted Amount:	Department/ Requestor: Planning and Zoning Commission/ Developer Ron Haynes
Fund Balance-before expenditure:	Prepared by: City Administrator Flanigan
Estimated Cost:	Date Prepared: April 16, 2015
Exhibits:	1. City Engineer Review Letter 2. Proposed Preliminary Plat

### AGENDA SUBJECT

CONSIDERATION AND/OR ANY APPROPRIATE ACTION ON A PRELIMINARY PLAT FOR SOUTHRIDGE ESTATES EAST (FORMERLY KNOWN AS SOUTHRIDGE ESTATES PHASE 3); BEING 50± ACRES GENERALLY LOCATED SOUTHWEST OF CURTIS LANE AND LEWIS LANE [P&Z]

### SUMMARY

#### Planning and Zoning Minutes from March 12, 2015

1. CONSIDERATION AND/OR ANY APPROPRIATE ACTION ON A PRELIMINARY PLAT FOR SOUTHRIDGE ESTATES PHASE 3; BEING 50± ACRES GENERALLY LOCATED SOUTHWEST OF CURTIS LANE AND LEWIS LANE.

MOTION: Councilmember Leamy moved to approve the preliminary plat subject to engineer review and approval. Commissioner Lozano seconded with Commissioners Wright, Lozano, Leamy, Sutaria and Stanislav voting for. Motion carried 5-0.

### POSSIBLE ACTION

Approve, Table, Deny

Inter - Office Use			
Approved by:			
Department Head/ Requestor:		Date:	
City Attorney:		Date:	
City Administrator:	<i>Taffy Flan</i>	Date:	<i>4/17/15</i>

**BIRKHOFF, HENDRICKS & CARTER, L.L.P.**  
**PROFESSIONAL ENGINEERS**

11910 Greenville Ave., Suite 600

Dallas, Texas 75243

Fax (214) 461-8390

Phone (214) 361-7900

JOHN W. BIRKHOFF, P.E.  
GARY C. HENDRICKS, P.E.  
JOE R. CARTER, P.E.  
MATT HICKEY, P.E.  
ANDREW MATA, JR., P.E.  
JOSEPH T. GRAJEWSKI, III, P.E.  
DEREK B. CHANEY, P.E.  
CRAIG M. KERKHOFF, P.E.

April 15, 2015

Mr. Jeff Flanigan  
City of Parker  
5700 E. Parker Rd.  
Parker, Texas 75002

Re: Southridge Estates Addition – Phase 3

Dear Mr. Flanigan:

As requested, we have reviewed the Preliminary Plat and Engineering Plans for the Southridge Addition Phase 3, prepared by Petit Berazza. The plans have been submitted electronically for our review with the latest revisions being submitted on April 14, 2015.

Our review of the Preliminary Plat and Engineering Plans is for general compliance with the City of Parker's development requirements and good engineering practice, and does not relieve the engineer of record of his responsibilities under the Texas Engineering Practice Act and Texas Surveyor's Act. Listed below are the comments regarding the plans:

**Comments**

1. Provide written approval from Collin County to abandon the ROW shown.
2. The proposed development is increasing the stormwater flow on the tract of land downstream from this property. The engineer of record has stated throughout the design process that the increase in flow is not adversely impacting the downstream tract. The plans as submitted show a rise in the 100-year water surface elevation of 0.02-feet, and the width of flow on the downstream tract was increased to 410.50-feet from 404.50-feet.
3. Grading plans shall show the proposed contours into the headwall and driveway along Curtis Lane.

Mr. Jeff Flanigan  
City of Parker  
April 15, 2015  
Page 2 of 2

Pending resolution of the above items, we offer no further objections. We are available to discuss our review comments further at your convenience.

Sincerely,



Craig M. Kerkhoff, P.E.

Enclosures



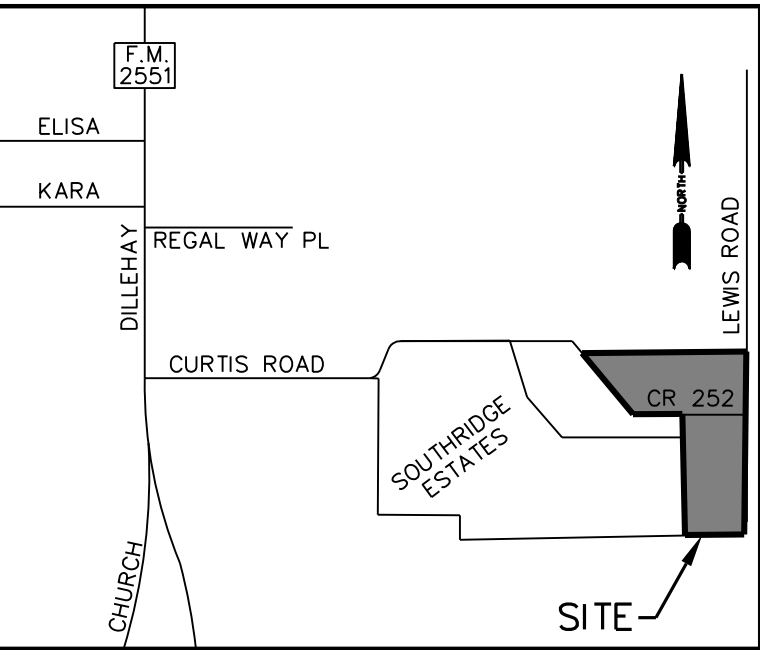
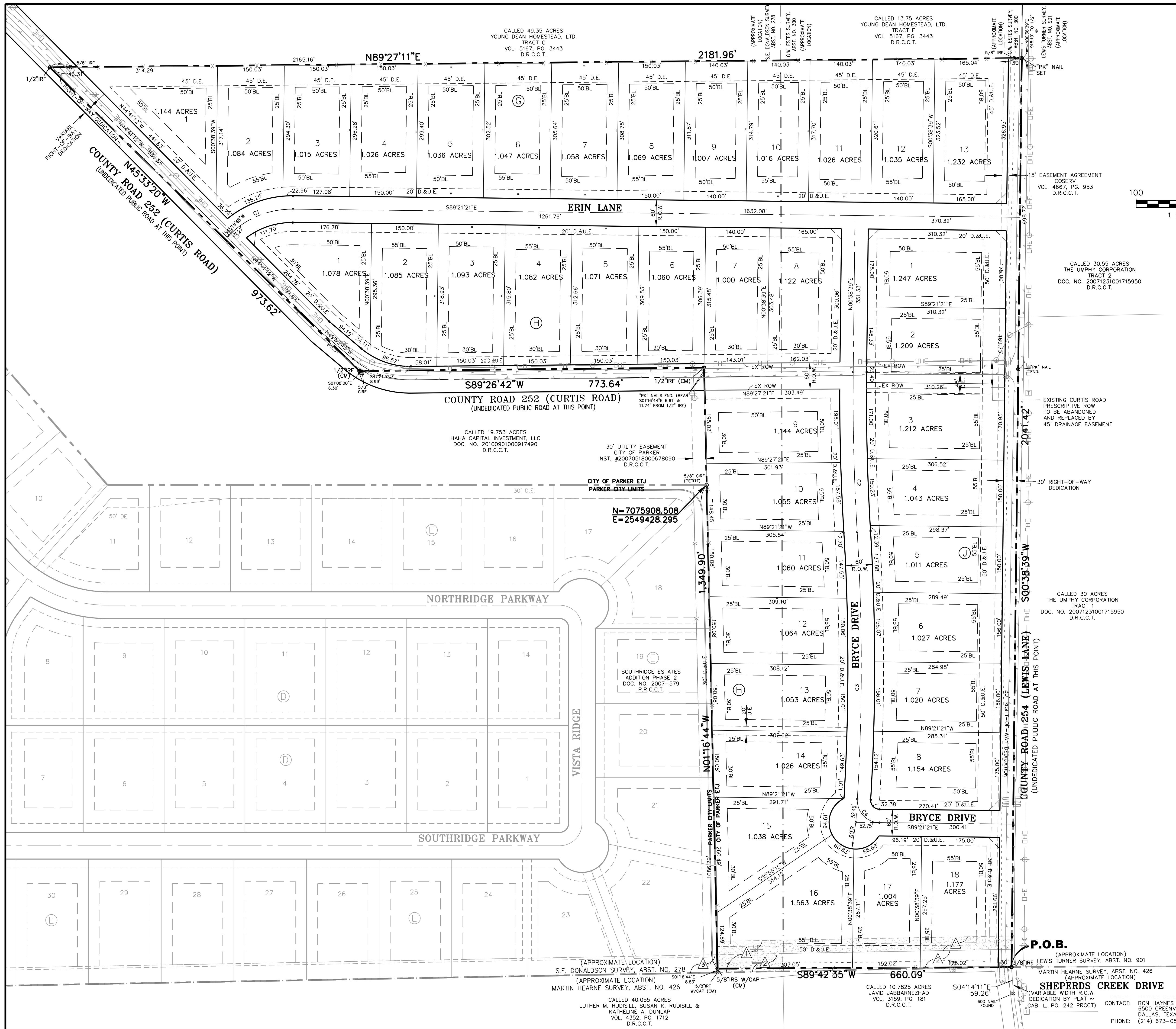

VICINITY MAP  
N.T.S.

LEGEND

U.E.	UTILITY EASEMENT
D.E.	DRAINAGE EASEMENT
D.&U.E.	DRAINAGE & UTILITY EASEMENT
V.E.	VISIBILITY EASEMENT
BL	BUILDING SETBACK LINE
5/8"IRS	5/8-INCH IRON ROD W/CAP MARKED "PETITT-RPLS 4087" SET
1/2"IRF	IRON ROD FOUND
◆	DENOTES STREET NAME CHANGE
R.O.W.	RIGHT-OF-WAY
P.O.B.	POINT OF BEGINNING
60'R	60-FOOT RADIUS
NTMWD	NORTH TEXAS MUNICIPAL WATER DISTRICT EASEMENT

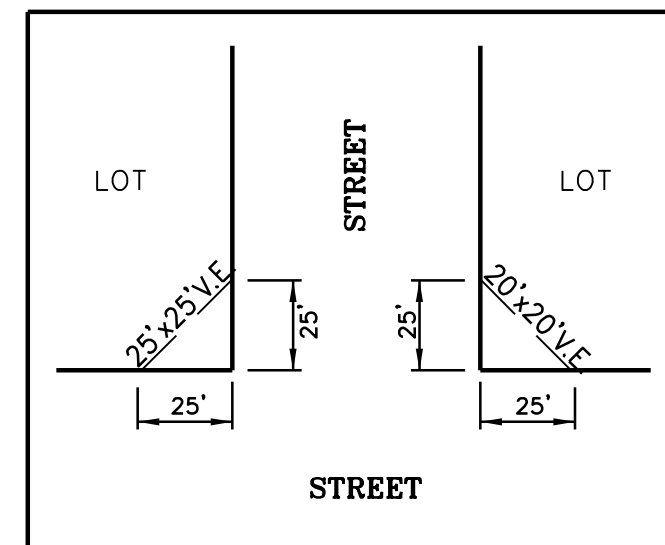

25'x25' VISIBILITY EASEMENT (TYP.)

CURVE TABLE					
CURVE	CHORD DIRECTION	CHORD	DELTA	RADIUS	LENGTH
C1	S67°58'44"W	154.14	45°19'51"	200.00	158.23
C2	S01°24'49"E	359.10	4°06'57"	5000.00	359.18
C3	N00°01'52"W	600.12	6°52'51"	5000.00	600.48
C4	S42°58'23"E	72.40	92°45'54"	50.00	80.95

- ⚠ ELECTRIC LINE EASEMENT & RIGHT-OF-WAY  
GRAYSON COLLIN ELECTRIC COOPERATIVE, INC.  
DOC. NO. 20110920000999120, D.R.C.C.T.  
(HATCHED AREA)
- ⚠ 40' EASEMENT/RIGHT-OF-WAY  
NORTH TEXAS MUNICIPAL WATER DISTRICT  
CC#96-0015194, D.R.C.C.T.
- ⚠ 40' EASEMENT/RIGHT-OF-WAY  
NORTH TEXAS MUNICIPAL WATER DISTRICT  
CC#95-25333, D.R.C.C.T.

NTMWD EASEMENT NOTES

1. THE FOLLOWING NOTES ARE PER 40' EASEMENT/RIGHT-OF-WAY - NORTH TEXAS MUNICIPAL WATER DISTRICT CC#95-25333, D.R.C.C.T.
2. THE NTMWD EASEMENT GRANTS THE RIGHT TO CONSTRUCT, OPERATE, RECONSTRUCT, PERPETUALLY MAINTAIN AND REMOVE A PIPELINE FOR THE TRANSPORTATION OF WATER, WITH ALL INCIDENTAL EQUIPMENT, AND APPURTENANCES. NTMWD EASEMENT ALSO GRANTS RIGHT OF INGRESS AND EGRESS FOR ALL PURPOSES INCIDENTAL ABOVE SAID ITEMS.
3. PROPERTY OWNERS SHALL HAVE THE RIGHT FULLY TO USE AND ENJOY THE SAID PREMISES COVERED BY SAID ABOVE DESCRIBED EASEMENT EXCEPT FOR THE PURPOSE OF ERECTING BUILDINGS OR PERMANENT STRUCTURES ON AND OVER SAID RIGHT-OF-WAY.

PRELIMINARY PLAT  
SOUTHRIDGE ESTATES PHASE 3

50.104 ACRES - 39 RESIDENTIAL LOTS  
SITUATED IN THE  
G.W. EASTES SURVEY, ABSTRACT NO. 300  
S.E. DONALDSON SURVEY, ABSTRACT NO. 278  
CITY OF PARKER'S ETJ, COLLIN COUNTY, TEXAS



1651 Glenville Drive, Suite 208  
Richardson, Texas 75081  
Tel. No. (214) 221-9955  
Fax No. (214) 340-3550  
DATE: AUGUST 2014  
SCALE: 1"= 100'

CONTACT: RON HAYNES  
6500 GREENVILLE AVENUE, SUITE 350  
DALLAS, TEXAS 75206  
PHONE: (214) 673-0575



OWNER'S CERTIFICATE

STATE OF TEXAS     §

COUNTY OF COLLIN   §

WHEREAS, HAYNES DEVELOPMENT COMPANY, IS THE OWNER OF A TRACT OF LAND SITUATED IN THE GEORGE W. EASTES SURVEY, ABSTRACT NO. 300, AND THE SURRY E. DONALDSON SURVEY, ABSTRACT NO. 278, IN COLLIN COUNTY, TEXAS, AND BEING ALL OF THAT CERTAIN TRACT OF LAND DESCRIBED IN DEED TO CHEN AND WANG PARKER CITY JOINT VENTURE RECORDED IN DOCUMENT NO. 97-0014688, OF THE DEED RECORDS OF COLLIN COUNTY, TEXAS (DRCCT), SUBJECT PROPERTY BEING MORE PARTICULARLY DESCRIBED AS FOLLOWS:

BEGINNING AT A 3/8 INCH IRON ROD FOUND, SAID IRON ROD BEING LOCATED IN THE APPROXIMATE CENTER OF COUNTY ROAD 254 (LEWIS LANE – UNDEDICATED AT THIS POINT), AND ALSO BEING LOCATED AT THE SOUTHEAST CORNER OF SAID CHEN AND WANG PARKER CITY JOINT VENTURE TRACT, THE NORTHEAST CORNER OF THAT CERTAIN TRACT OF LAND DESCRIBED IN DEED TO JAVID JABBARNEZHAD RECORDED IN VOLUME 3159, PAGE 181, DRCCT, AND BEING THE NORTHWEST CORNER OF A RIGHT-OF-WAY DEDICATION BY PLAT FOR LEWIS LANE AND SHEPERDS CREEK DRIVE ACCORDING TO PLAT RECORDED IN CABINET L, PAGE 242, OF THE PLAT RECORDS OF COLLIN COUNTY, TEXAS (PRCCT);

THENCE SOUTH 89°42'35" WEST, WITH THE SOUTH LINE OF SAID CHEN AND WANG PARKER CITY JOINT VENTURE TRACT, A DISTANCE OF 660.09 FEET TO A 5/8 INCH IRON ROD WITH CAP MARKED "PETITT-RPLS 4087" SET FOR CORNER, SAID IRON ROD BEING LOCATED ON THE EAST LINE OF SOUTHRIDGE ESTATES ADDITION PHASE 2, AN ADDITION TO THE CITY OF PARKER, TEXAS ACCORDING TO FINAL PLAT RECORDED IN DOCUMENT NO. 2007-579, PRCCCT, FROM WHICH A 5/8 INCH IRON ROD WITH CAP MARKED "PETITT-RPLS 4087" FOUND BEARS SOUTH 01°16'44" EAST, A DISTANCE OF 8.83 FEET;

THENCE NORTH 01°16'44" WEST, WITH SAID EAST LINE OF SOUTHRIDGE ESTATES ADDITION PHASE 2, PASSING AT A DISTANCE OF 1086.29 FEET A 5/8 INCH IRON ROD WITH CAP MARKED "PETITT-RPLS 4087" FOUND AT THE MOST SOUTHERLY NORTHEAST CORNER OF SOUTHRIDGE ESTATES ADDITION PHASE 2, CONTINUING WITH THE EAST LINE OF THAT CERTAIN TRACT OF LAND DESCRIBED IN DEED TO HAHA CAPITAL INVESTMENT, LLC RECORDED IN DOCUMENT NO. 20100901000917490, DRCCT, IN ALL, A DISTANCE OF 1349.90 FEET TO A "PK" NAIL IN ASPHALT FOUND FOR CORNER, SAID NAIL LOCATED ALONG COUNTY ROAD 252 (CURTIS ROAD – UNDEDICATED AT THIS POINT);

THENCE SOUTH 89°26'42" WEST, WITH A NORTH LINE OF SAID HAHA CAPITAL INVESTMENT, LLC TRACT, A SOUTH LINE OF THE AFOREMENTIONED CHEN AND WANG PARKER CITY JOINT VENTURE TRACT, AND GENERALLY ALONG COUNTY ROAD 252 (CURTIS ROAD), A DISTANCE OF 773.64 FEET TO A 1/2 INCH IRON ROD FOUND FOR CORNER, FROM WHICH A 5/8 INCH CAPPED IRON ROD FOUND BEARS SOUTH 47°21'52" EAST, A DISTANCE OF 8.99 FEET;

THENCE NORTH 45°33'20" WEST, WITH A NORTHEAST LINE OF THE HAHA CAPITAL INVESTMENT, LLC TRACT, A SOUTHWEST LINE OF SAID CHEN AND WANG PARKER CITY JOINT VENTURE TRACT, AND GENERALLY ALONG COUNTY ROAD 252 (CURTIS ROAD), A DISTANCE OF 973.62 FEET TO A 1/2 INCH IRON ROD FOUND FOR CORNER;

THENCE NORTH 89°27'11" EAST, WITH THE NORTH LINE OF THE CHEN AND WANG PARKER CITY JOINT VENTURE TRACT, AND THE SOUTH LINE OF THOSE CERTAIN TRACTS OF LAND DESCRIBED AS TRACT C AND TRACT F IN DEED TO YOUNG DEAN HOMESTEAD, LTD. RECORDED IN VOLUME 5167, PAGE 3443, DRCCT, PASSING AT A DISTANCE OF 46.31 FEET A 5/8 INCH IRON ROD FOUND, AND PASSING AT A DISTANCE OF 2165.16 FEET A 5/8 INCH IRON ROD FOUND, CONTINUING IN ALL, A DISTANCE OF 2181.96 FEET TO A "PK" NAIL SET IN ASPHALT IN THE AFOREMENTIONED COUNTY ROAD 254 (LEWIS LANE), FROM WHICH A 1/2 INCH IRON ROD FOUND BEARS NORTH 00°38'39" EAST, A DISTANCE OF 915.19 FEET;

THENCE SOUTH 00°38'39" WEST, WITH SAID COUNTY ROAD 254 (LEWIS LANE), PASSING AT A DISTANCE OF 698.72 FEET A "PK" NAIL IN ASPHALT FOUND AT THE APPROXIMATE CENTERLINE INTERSECTION OF COUNTY ROAD 254 (LEWIS LANE) AND THE AFOREMENTIONED COUNTY ROAD 252 (CURTIS ROAD), CONTINUING IN ALL, A DISTANCE OF 2041.42 FEET TO THE POINT OF BEGINNING OF HEREIN DESCRIBED TRACT, CONTAINING A CALCULATED AREA OF 50.104 ACRES OF LAND.

OWNER'S DEDICATION

NOW THEREFORE, KNOW ALL MEN BY THESE PRESENTS:

THAT HAYNES DEVELOPMENT COMPANY, A TEXAS CORPORATION, THROUGH THE UNDERSIGNED AUTHORITIES, DOES HEREBY ADOPT THIS PLAT DESIGNATING THE HEREIN ABOVE DESCRIBED PROPERTY AS SOUTHRIDGE EAST ADDITION, AN ADDITION TO THE CITY OF PARKER, COLLIN COUNTY, TEXAS, AND DOES HEREBY DEDICATE TO THE CITY OF PARKER, TEXAS, FOR PUBLIC USE FOREVER THE STREETS AND ALLEYS SHOWN HEREON AND DOES HEREBY RESERVE THE EASEMENT STRIPS SHOWN ON THIS PLAT FOR THE MUTUAL USE AND ACCOMMODATION OF THE CITY OF PARKER AND ALL PUBLIC UTILITIES DESIRING TO USE OR USING THE SAME. THE CITY OF PARKER, TEXAS, OR ANY PUBLIC UTILITY SHALL HAVE THE RIGHT TO REMOVE AND KEEP REMOVED ALL OR PART OF ANY BUILDINGS, FENCES, TREES, SHRUBS OR OTHER IMPROVEMENTS OR GROWTHS WHICH IN ANY WAY ENDANGER OR INTERFERE WITH THE CONSTRUCTION, MAINTENANCE OR EFFICIENCY OF ITS RESPECTIVE SYSTEMS ON ANY OF THESE EASEMENTS STRIPS. THE CITY OF PARKER AND ANY PUBLIC UTILITY SHALL AT ALL TIMES HAVE THE RIGHT OF INGRESS AND EGRESS TO OR FROM AND UPON THE SAID EASEMENT STRIPS FOR THE PURPOSE OF CONSTRUCTING, RECONSTRUCTING, INSPECTING, PATROLLING, MAINTAINING AND ADDING TO OR REMOVING ALL OR PART OF ITS RESPECTIVE SYSTEMS WITHOUT THE NECESSITY AT ANY TIME OF PROCURING THE PERMISSION OF ANYONE. THIS PLAT APPROVED SUBJECT TO ALL PLATTING ORDINANCES, RULES, REGULATIONS AND RESOLUTIONS OF THE CITY OF PARKER, TEXAS.

WITNESS MY HAND THIS \_\_\_\_ DAY OF \_\_\_\_\_, 2015

HAYNES DEVELOPMENT COMPANY

BY: \_\_\_\_\_  
RON HAYNES

STATE OF TEXAS     §

COUNTY OF DALLAS   §

BEFORE ME, THE UNDERSIGNED AUTHORITY, A NOTARY PUBLIC IN AND FOR THE STATE OF TEXAS, ON THIS DAY PERSONALLY APPEARED RON HAYNES, PRESIDENT OF HAYNES DEVELOPMENT COMPANY, KNOWN TO ME TO BE THE PERSON AND OFFICER WHOSE NAME IS SUBSCRIBED TO THE FOREGOING INSTRUMENT AND ACKNOWLEDGED TO ME THAT HE EXECUTED THE SAME FOR THE PURPOSES AND CONSIDERATION THEREIN EXPRESSED AND IN THE CAPACITY THEREIN STATED.

GIVEN UNDER MY HAND AND SEAL OF OFFICE, THIS \_\_\_\_\_ DAY OF \_\_\_\_\_, 2015.

\_\_\_\_\_  
NOTARY PUBLIC IN AND FOR THE STATE OF TEXAS.

MY COMMISSION EXPIRES: \_\_\_\_\_

SURVEYOR'S CERTIFICATE

KNOW ALL MEN BY THESE PRESENTS:

THAT I, JIMMIE D. NICHOLS, A REGISTERED PROFESSIONAL LAND SURVEYOR, HEREBY CERTIFY THAT THIS PLAT WAS PREPARED FROM AN ACTUAL SURVEY MADE ON THE GROUND OF THE LAND DESCRIBED HEREON, AND THAT THE CORNER MONUMENTS SHOWN HEREON WERE PROPERLY PLACED OR FOUND UNDER MY PERSONAL SUPERVISION IN ACCORDANCE WITH THE CITY OF PARKER SUBDIVISION REGULATIONS.

"PRELIMINARY. THIS DOCUMENT SHALL NOT BE RECORDED FOR ANY PURPOSE AND SHALL NOT BE USED OR VIEWED OR RELIED UPON AS A FINAL SURVEY DOCUMENT"

\_\_\_\_\_  
JIMMIE D. NICHOLS  
REGISTERED PROFESSIONAL LAND SURVEYOR NO. 5184

STATE OF TEXAS     §

COUNTY OF COLLIN   §

BEFORE ME, THE UNDERSIGNED AUTHORITY, A NOTARY PUBLIC IN AND FOR THE STATE OF TEXAS, ON THIS DAY PERSONALLY APPEARED BRIAN R. WADE, KNOWN TO ME TO BE THE PERSON WHOSE NAME IS SUBSCRIBED TO THE FOREGOING INSTRUMENT AND ACKNOWLEDGED TO ME THAT HE EXECUTED THE SAME IN THE CAPACITY THEREIN STATED.

GIVEN UNDER MY HAND AND SEAL OF OFFICE, THIS \_\_\_\_\_ DAY OF \_\_\_\_\_, 2015.

\_\_\_\_\_  
NOTARY PUBLIC IN AND FOR THE STATE OF TEXAS.

MY COMMISSION EXPIRES: \_\_\_\_\_

NOTES:

- SELLING A PORTION OF THIS ADDITION BY METES AND BOUNDS IS A VIOLATION OF CITY ORDINANCES AND STATE LAW AND IS SUBJECT TO FINES AND WITHHOLDING OF UTILITIES AND BUILDING PERMITS.
- BEARINGS SHOWN HEREON ARE BASED ON A CALL OF NORTH 01 DEGREE 16 MINUTES 44 SECONDS WEST ALONG THE EAST LINE OF SOUTHRIDGE ESTATES ADDITION PHASE 2, AN ADDITION TO THE CITY OF PARKER, COLLIN COUNTY, TEXAS ACCORDING TO THE PLAT THEREOF RECORDED AS DOCUMENT NO. 2007-579, PLAT RECORDS, COLLIN COUNTY, TEXAS, AS MONUMENTED ON THE GROUND.
- THE SUBJECT TRACT IS DEPICTED WITHIN ZONE X (UNSHADED) ON THE FLOOD INSURANCE RATE MAPS, MAP NUMBER 48085C0405J, DATED JUNE 2, 2009. ZONE X (UNSHADED) IS DEFINED THEREON AS "AREAS DETERMINED TO BE OUTSIDE THE 0.2% ANNUAL CHANCE FLOODPLAIN."
- 1" IRON RODS WILL BE SET @ UNMONUMENTED BOUNDARY CORNERS AND BLOCK CORNERS, ALL OTHER'S WILL BE 5/8" IRON RODS WITH CAPS MARKED "PETITT-RPLS 4087"

CITY APPROVALS:	
APPROVED: CHAIRMAN, PLANNING AND ZONING COMMISSION	DATE
APPROVED: MAYOR	DATE
APPROVED: CITY ENGINEER	DATE

PRELIMINARY PLAT  
SOUTHRIDGE EAST ADDITION  
50.104 ACRES – 39 RESIDENTIAL LOTS  
SITUATED IN THE  
G.W. EASTES SURVEY, ABSTRACT NO. 300  
S.E. DONALDSON SURVEY, ABSTRACT NO. 278  
CITY OF PARKER'S ETJ, COLLIN COUNTY, TEXAS



CONTACT: RON HAYNES  
6500 GREENVILLE AVENUE, SUITE 350  
DALLAS, TEXAS 75206  
PHONE: (214) 673-0575

1651 Glenville Drive, Suite 208  
Richardson, Texas 75081  
Tel. No. (214) 221-9955  
Fax No. (214) 340-3550  
DATE: AUGUST 2014  
SCALE: 1"= 100'  
JOB NO. 05003-03



## Council Agenda Item

Budget Account Code:	Meeting Date: April 21, 2015
Budgeted Amount:	Department/ Requestor: TXDoT
Fund Balance-before expenditure:	Prepared by: City Attorney Shepherd
Estimated Cost:	Date Prepared: April 15, 2015
Exhibits:	1) Proposed Resolution and Agreement

### AGENDA SUBJECT

APPROVAL OF RESOLUTION 2015-469 APPROVING AN AGREEMENT BETWEEN THE CITY OF PARKER AND THE TEXAS DEPARTMENT OF TRANSPORTATION (TXDoT) FOR LANDSCAPING AND MAINTENANCE OF FM 2551 [SHEPHERD]

### SUMMARY

The widening of FM 2551 is a TXDoT project. Parker has requested for TXDoT to landscape the project, primarily the median with no cost to the City; however, the City will have to maintain the median. This agreement authorizes that request. Several provisions will need discussion.

Council minutes September 2, 2014:

CONSIDERATION AND/OR ANY APPROPRIATE ACTION ON RESOLUTION 2014-459 APPROVING AN AGREEMENT WITH TEXAS DEPARTMENT OF TRANSPORTATION FOR LANDSCAPING ALONG F.M. 2551/HOGGE ROAD. [FLANIGAN]

City Administrator Flanigan and Resident Eleanor Evans met with the Texas Department of Transportation (TXDoT) on behalf of the City and requested additional trees and landscaping in the right of way of FM2551/Hogge Road, as a part of the TXDoT road widening project. TXDoT has consented to the additional landscaping, so long as Parker does all maintenance at the City's expense. TXDoT will pay for the trees, installation and irrigation system.

City Attorney Shepherd requested Council table this item to allow additional time to discuss the termination clause of the contract with TXDoT.

MOTION: Councilmember Pettie moved to table this item to a future date. Councilmember Taylor seconded with Councilmembers Stone, Standridge, Levine, Pettie and Taylor voting for. Motion carried 5-0.

### **POSSIBLE ACTION**

Approve, Deny, Modify, table

Inter - Office Use			
Approved by:			
Department Head/ Requestor:		Date:	
City Attorney:		Date:	
City Administrator:		Date:	4/17/15



**RESOLUTION NO. 2014-459**  
*(FM 2551 Landscaping and Maintenance Agreement)*

**A RESOLUTION OF THE CITY OF PARKER, COLLIN COUNTY, TEXAS,  
PROVIDING FOR THE EXECUTION OF AN AGREEMENT BETWEEN  
THE CITY OF PARKER AND THE TEXAS DEPARTMENT OF  
TRANSPORTATION (TXDoT) FOR LANDSCAPING AND MAINTENANCE  
OF FM 2551**

**WHEREAS**, the City of Parker is authorized by state law to execute an interlocal agreement for Landscaping and Maintenance in and along FM 2551- Hogge Road; and

**WHEREAS**, the City of Parker finds that landscaping the newly widened FM 2551 is in the best interest of its residents; and

**WHEREAS**, The City of Parker has budgeted sufficient funds to carry out the terms of the proposed agreement with TXDoT;

**NOW, THEREFORE, BE IT RESOLVED BY THE CITY COUNCIL OF PARKER, COLLIN COUNTY, TEXAS:**

**SECTION 1.** The Parker City Council does authorize the Mayor to enter into an agreement with TXDoT for Landscaping and Maintenance of that portion of FM 2551 described in the attached interlocal agreement in substantially the form attached hereto.

**SECTION 2.** This resolution shall be effective upon its passage.

**APPROVED AND ADOPTED this \_\_\_\_\_ day of \_\_\_\_\_, 2014.**

\_\_\_\_\_  
Z Marshall, Mayor

ATTEST:

\_\_\_\_\_  
Carrie L. Smith, City Secretary

APPROVED TO FORM:

\_\_\_\_\_  
James E. Shepherd, City Attorney

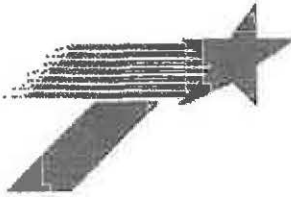

## **Texas Department of Transportation**

**4777 East Highway 80, Mesquite, Texas 75150-6643**

**August 19, 2014**

**Landscape Maintenance Agreement**

**CSJ: 2056-01-048**

**FM 2551**

**City of Parker**

**Collin County**

**Mr. Jeff Flanigan**

**City Administrator**

**City of Parker**

**5700 E. Parker Rd.**

**Parker, TX 75002**

**Dear Mr. Flanigan:**

Please find attached, two (2) original *Landscape Maintenance Agreements* for the subject project for your review and approval. If all is satisfactory, please obtain authorized signatures for both originals and return both further processing. A fully executed original will be returned to you for your files and use.

Feel free to contact Mr. Pat Haigh at 214-320-6205, if needed.

Sincerely,

**Andrew R. Oberlander, P.E.**

**District Transportation Operations Engineer**

**Attachments**

## LANDSCAPE MAINTENANCE AGREEMENT

**THE STATE OF TEXAS**

**THE COUNTY OF TRAVIS**

This AGREEMENT made this \_\_\_\_\_ day of \_\_\_\_\_, 20\_\_\_\_, by and between the Texas Department of Transportation, hereinafter referred to as the "State," and the City of Parker, Collin County, Texas, acting by and through its duly authorized officers, hereinafter called the "City".

### WITNESSETH

**WHEREAS**, Chapter 311 of the Transportation Code gives the City exclusive dominion, control, and jurisdiction over and under the public streets within its corporate limits and authorizes the City to enter into agreements with the State to fix responsibilities for maintenance, control, supervision, and regulation of State highways within and through its corporate limits; and

**WHEREAS**, Section 221.002 of the Transportation Code authorizes the State, at its discretion, to enter into agreements with cities to fix responsibilities for maintenance, control, supervision, and regulation of State highways within and through the corporate limits of such cities; and

**WHEREAS**, the State and the City have entered into a Municipal Maintenance Agreement dated September 20, 1994, the provisions of which are incorporated herein by reference, and wherein the City has agreed to retain all functions and responsibilities for maintenance and operations which are not specifically described as the responsibility of the department; and

**WHEREAS**, the State has existing and proposed landscape improvements, such as, but not limited to, the installation of tree, shrub, and turf plantings, irrigation systems, and other aesthetic elements for areas within the right of way of state highway routes within the City as shown on Attachment "A"; and

**WHEREAS**, the State will provide such landscape improvements, provided that the City agrees to be responsible for all required maintenance of the landscape improvements.

## AGREEMENT

**NOW, THEREFORE**, in consideration of the premises and of the mutual covenants and agreements of the parties hereto to be by them respectively kept and performed, it is agreed as follows:

### Contract Period

This Agreement becomes effective upon the date of final execution by the State, and shall remain in effect until terminated or modified as hereinafter provided.

### Coverage

This agreement prescribes the responsibilities of the State and the City relating to the installation and maintenance of landscape elements on non-controlled access state highways, as defined in the Municipal Maintenance Agreement, and described and graphically shown as "State Maintained and Operated" in that agreement.

### Amendment

The parties agree that this agreement may be amended. Such amendments, to be effective, must be in writing and signed by both parties.

### State's Responsibilities

The State shall install landscape elements including but not limited to trees, shrubs, grasses, sidewalks, irrigation systems, and hardscape features through its employees or duly appointed agents.

### City's Responsibilities

The City may install landscape elements including but not limited to trees, shrubs, grasses, sidewalks, irrigation systems, and hardscape features through its employees or duly appointed agents. Any installations shall be performed in accordance with Texas Department of Transportation specifications and standards, and must be approved by the State in writing prior to any work being performed.



The City shall maintain all landscape elements within the limits of the right of way including all median and island areas but excluding paved areas intended for vehicular travel. Landscape maintenance shall include but not be limited to plant maintenance, plant replacement, mowing and trimming, hardscape element maintenance, and irrigation system operation and maintenance. All landscape elements must be maintained in a functional and aesthetically pleasing condition.

### TERMINATION

It is understood and agreed between the parties hereto that should either party fail to properly fulfill its obligations as herein outlined, the other party may terminate this agreement upon thirty days written notice. Additionally, this agreement may be terminated by mutual agreement and consent of both parties.

Should the City terminate this agreement, as prescribed here above, the City shall, at the option of the State, reimburse any reasonable costs incurred by the State.

IN WITNESS WHEREOF, the parties have hereunto affixed their signatures, the City of Parker on the \_\_\_\_\_ day of \_\_\_\_\_, year 2014, and the Texas Department of Transportation, on the \_\_\_\_\_ day of \_\_\_\_\_, year 2014.

ATTEST:

CITY OF Parker

By Mayor Z Marshall  
(Title of Signing Official)

THE STATE OF TEXAS

Executed for the Executive Director and approved for the Texas Transportation Commission for the purpose and effect of activating and/or carrying out the orders, and the established policies or work programs heretofore approved and authorized by the Texas Transportation Commission.

By \_\_\_\_\_  
District Engineer  
Dallas  
District

Attachments

# FINAL PLANS

NAME OF CONTRACTOR: \_\_\_\_\_  
 DATE OF LETTING: \_\_\_\_\_  
 DATE WORK BEGAN: \_\_\_\_\_  
 DATE WORK COMPLETED: \_\_\_\_\_  
 DATE WORK ACCEPTED: \_\_\_\_\_  
 SUMMARY OF CHANGE ORDERS: \_\_\_\_\_

## STATE OF TEXAS DEPARTMENT OF TRANSPORTATION

### PLANS OF PROPOSED STATE HIGHWAY IMPROVEMENT

FEDERAL AID PROJECT  
 STP 2015 (223)  
 CSJ 2056-01-048  
**FM 2551**  
**DALLAS COUNTY**

SECTION	FEDERAL AID or STATE PROJECT NO.	PROJECT NO.
EBB	STP 2015 (223)	FM 2551
BBB	DISTRICT	COUNTY
CCC	TEXAS DALLAS	COLLIN
DDD	CONTRACT	SECTION
EEE	2056	01 048
FFF		1

DESIGN SPEEDS - N/A

#### NOTE:

SPECIFICATIONS ADOPTED BY THE TEXAS DEPARTMENT OF TRANSPORTATION, DATE 1, 2004, AND THE CONTRACT PROVISIONS LISTED AND DATED AS FOLLOWS SHALL APPLY TO THIS PROJECT. SECURED CONTRACT PROVISIONS FOR ALL FEDERAL-AID CONSTRUCTION CONTRACTS (FORM FPM-1273, MAY, 2012)

LIMITS: FROM FM 544  
 TO FM 2514 (PARKER RD)

ROADWAY = 15,840 FT. = 3.090 MI.  
 BRIDGE = 0.00 FT. = 0.000 MI.  
 TOTAL LENGTH OF PROJECT = 15,840 FT. = 3.090 MI.

TYPE OF WORK: FOR THE CONSTRUCTION OF LANDSCAPE DEVELOPMENT  
 TO INCLUDE: TREE AND SHRUB PLANTING, BED  
 PREPARATION AND IRRIGATION

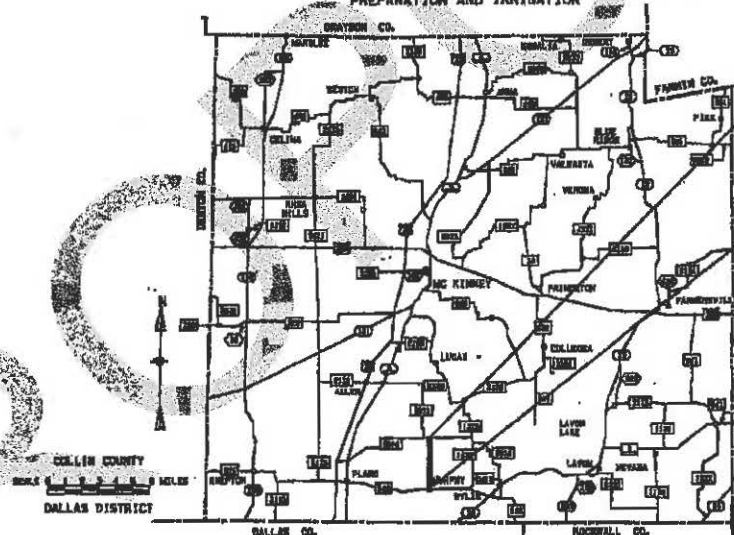

BEGIN PROJECT  
 CSJ 2056-01-048  
 STA N/A  
 TRM 246 + 1.550

END PROJECT  
 CSJ 2056-01-048  
 STA N/A  
 TRM 250 + 0.578

## TEXAS DEPARTMENT OF TRANSPORTATION

SUBMITTED FOR LETTING: 4/18/2014

LANDSCAPE ARCHITECT

RECOMMENDED FOR LETTING: AUG 11 20

BARRY HEARD, P.E.

AREA ENGINEER

RECOMMENDED FOR LETTING: 8/13/2014

DIRECTOR OF OPERATIONS

RECOMMENDED FOR LETTING: 8/13/2014

DISTRICT ENGINEER

APPROVED FOR LETTING: 20

DIRECTOR, TRAFFIC OPERATIONS DIVISION

APPROVED FOR LETTING: 20

DIRECTOR, DESIGN DIVISION

WORK WAS COMPLETED ACCORDING  
 TO THE PLANS AND CONTRACT.

Signature of Registrar: \_\_\_\_\_ Date: \_\_\_\_\_

# INDEX OF SHEETS

SHEET DESCRIPTION

## I. GENERAL

1 TITLE SHEET  
2 INDEX OF SHEETS  
3 - 3B GENERAL NOTES  
4 ESTIMATE AND QUANTITY SHEET

SHEET DESCRIPTION

## V. DRAINAGE DETAILS

NONE

SHEET DESCRIPTION

## VIII. TRAFFIC ITEMS

NONE

## II. TRAFFIC CONTROL PLAN

5 TSP (1-5) 12  
6 TSP (2-6) 12  
7 TSP (2-6) 12  
8 TSP (5-2) 12  
9 - 20 SC (1-12) 13

## VI. UTILITIES

NONE

## IX. ENVIRONMENTAL ISSUES

21 ENVIRONMENTAL PERMITS, ISSUES AND COMMITMENTS (EPIC)  
22 STORM WATER POLLUTION PREVENTION PLAN (SWPPP)  
23 STORM WATER POLLUTION PREVENTION PLAN SHEET  
24 - 25 EROSION CONTROL LOGS (DAL)

## III. ROADWAY DETAILS

NONE

## VII. BRIDGES

NONE

## X. MISCELLANEOUS ITEMS

26 - 38 LANDSCAPE PLANTING PLANS  
37 LANDSCAPE PLANTING DETAILS  
38 - 48 IRRIGATION PLANS  
49 IRRIGATION DETAILS  
50 IRRIGATION GENERAL NOTES & MATERIAL SPECIFICATIONS

## IV. RETAINING WALL DETAILS

NONE



## INDEX OF SHEETS

\* THE STANDARD SHEETS SPECIFICALLY IDENTIFIED ABOVE HAVE BEEN SELECTED BY ME OR UNDER MY RESPONSIBLE SUPERVISION AS BEING APPLICABLE TO THIS PROJECT.

Signature of Registrant: J.D. Morrien Date: \_\_\_\_\_

SECTION	DATE	FEDERAL AID PROJECT NO.	STANDARD SHEET NO.
EBB	6	(see title sheet)	FM 2551
STATE	DISTRICT	COUNTY	SHEET
TEXAS	DALLAS	COLLIN	2
SECTION	SECTION	SECTION	
2056	01	046	

CSJ: 2056-01-048

Sheet 3

County: COLLIN

Highway: FM 2851

General Notes: Revised on May 9, 2014

### SW3P RESPONSIBILITIES

#### TxDOT Area of Responsibility

Responsible for the area defined by the limits of the subject project, except for those areas utilized and operated by the contractor. These areas include, though are not limited to, areas used for field offices, equipment and/or material storage, and concrete or asphalt plants.

#### TxDOT Operational Responsibility

Responsible for seeking coverage under the TPDES Construction General Permit (CGP) and operating the project within the requirements of the CGP for discharging storm water from the subject project and to notify MS4 permit holders of the intent to discharge storm water.

File a Notice of Termination with TCEQ upon completion of the project when the exposed areas have been stabilized with a vegetative cover of at least 70%.

#### Contractor Area of Responsibility

Responsible for all areas under their direct operational control which includes, though not limited to, areas used for field offices, equipment and/or material storage, and concrete or asphalt plants. These areas may be located on or off the subject project's R.O.W.

#### Contractor Operational Responsibility

Responsible for seeking coverage under the TPDES Construction General Permit (CGP) and adhering to all requirements of the permit for discharging storm water from the areas under their operational control. Perform regular inspections, prepare a written report of deficiencies, and repair deficiencies within the time frame set forth by the permit. File a Notice of Termination with TCEQ upon completion of the project when the exposed areas have been stabilized with a vegetative cover of at least 70%.

Responsible under contractual obligations to TxDOT to install, clean, repair, replace or remove sediment and erosion control devices as indicated on TxDOT's Inspection Reports, or as required by daily construction practices, within the time frame set forth by the permit.

### GENERAL

Access will be provided to all business and residences at all times. Where turning radii are limited during phased construction at intersections, provide all weather surfaces such as RAP or base in turning movements to accommodate and to protect the traffic from edge drop-offs. Materials, labor, maintenance and removal for these temporary accesses and radii will not be paid for directly but will be considered subsidiary to the various bid items.

General Notes

Sheet A

CSJ: 2056-01-048

Sheet 3

County: COLLIN

Highway: FM 2851

The construction, operation and maintenance of the proposed project will be consistent with the state Implementation plan as prepared by the Texas Commission on Environmental Quality.

The disturbed area for this project, as shown on the plans is 1.96 acres. However, the Total Disturbed Area (TDA) will establish the required authorization for storm water discharges. The TDA of this project will be determined by the sum of the disturbed area in all project locations in the contract, and all disturbed area on all Project-Specific Locations (PSL) located in the project limits and/or within 1 mile of the project limits. The department will obtain an authorization to discharge storm water from the Texas Commission on Environmental Quality (TCEQ) for the construction site as shown on the plans, according to the TDA of the project. The contractor will obtain any required authorization from the TCEQ for the discharge of storm water from any PSL for construction support activities on or off the project row according to the TDA of the project. When the TDA for the project exceeds 1 acre, provide a copy of the appropriate application of permit (NOI, or Construction Site Notice) to the engineer, for any PSL located in the project limits or within 1 mile of the project limits. Follow the directives and adhere to all requirements set forth in the TCEQ, Texas Pollution Discharge Elimination System, Construction General Permit (TPDES, CGP).

Leave all right of way areas undisturbed until actual construction is to be performed in said areas.

Use established industry and utility safety practices to erect poles, luminaries, signs or structures near any overhead or underground utility. Consult with the appropriate utility company prior to beginning such work.

Underground utilities owned by the Texas Department of Transportation may be present within the Right-Of-Way on this project. For signal, illumination, surveillance, and communications & control maintained by TxDOT, call the TxDOT Traffic Signal Office (214-320-8882) for locates a minimum of 48 hours in advance of excavation. For irrigation systems, call TxDOT Maintenance Landscape Office (214-320-8205) for locates a minimum of 48 hours in advance of excavation. If city or town owned irrigation facilities are present, call the appropriate department of the local city or town a minimum of 48 hours in advance of excavation. The Contractor is liable for all damages incurred to the above mentioned utilities when working without having the utilities located prior to excavation.

For the project to be deemed complete, permanently stabilize all unpaved disturbed areas of the project with a vegetative cover at a minimum of 70% density for the control of erosion.

Repair or replace any structures and utilities that might have been damaged by negligence or a failure to have utility locates performed.

Perform all electrical work in accordance with the National Electrical Code and Texas Department of Transportation Specifications.

Consult with appropriate electric company representatives according to their respective area to coordinate electrical services installations.

Meet weekly with the engineer to notify him or her of planned work for the upcoming week.

General Notes

Sheet B

ATTACHMENT

CSJ: 2055-01-048

Sheet 3A

County: COLLIN

Highway: FM 2551

Submit pre-letting questions, by email only, to the attention of Area Engineer or Assistant Area Engineer.

Email: [Barry.Heard@tcdot.gov](mailto:Barry.Heard@tcdot.gov) or [Brenan.Honey@tcdot.gov](mailto:Brenan.Honey@tcdot.gov)

Answers will be provided by email.

An electronic file containing pre-letting questions and TxDOT answers will be provided upon email request.

Material On Hand (MOH) will not be used in calculating partial payments for Mobilization.

Provide the Engineer with a copy of all Disadvantage Business Enterprise (DBE) subcontractor agreements prior to commencing work.

**Item 8:**

This Project will be a Standard Workweek in accordance with Article 8.3.A.4.

**Item 181:**

Provide tickets representing quantity of compost delivered to site.

**Item 170:**

For all meter locations, contact Parker or Murphy water utilities.

Parker:

Parker Water and Sanitation District (303.841.4827)

Cottonwood Water and Sanitation (303.792.9508)

Murphy:

North Texas Municipal Water District (972.442.5405)

**Item 182:**

No planting shall occur between June 1st and September 15th without written approval from the Engineer.

Maintain Median turf areas within project limits between a height of 2"-3" during the maintenance period under both Items 182 & 183.

Begin the 90-day maintenance period only after all live plant material and functional irrigation systems have been installed as shown on plans.

**Item 183:**

Begin the additional maintenance period covered under this item only after all maintenance activities have been completed under Items 170 & 182.

General Notes

Sheet C

CSJ: 2055-01-048

Sheet 3A

County: COLLIN

Highway: FM 2551

Replace dead or dying plant material within 10 days of notification by the Engineer unless otherwise indicated in the notification. Plant material replacement will be subsidiary to this item unless determined otherwise by the Engineer.

Continue to pay for water used through the irrigation meter during the maintenance period under this item. Transfer the meter to the City or appropriate Community Organization at the end of the project.

**Item 802:**

The Contractor Force Account "Safety Contingency" that has been established for this project is intended to be utilized for work zone enhancements, to improve the effectiveness of the Traffic Control Plan, that could not be foreseen in the project planning and design stage. These enhancements will be mutually agreed upon by the Engineer and the Contractor's Responsible Person based on weekly or more frequent traffic management reviews on the project. The Engineer may choose to use existing bid items if it does not slow the implementation of enhancement.

Provide written proposed lane closure information by 1:00 pm on the business day prior to the proposed closures. Do not close lanes when this requirement is not met.

When excavation is required next to a pavement lane carrying traffic and the widening is not completed by the end of the work day, backfill against the edge of the pavement with at least a 3:1 slope using an acceptable material to support vehicular traffic. Carefully remove and dispose of this material when work resumes. Backfilling pavement edges, and the materials required for the work will be subsidiary to this item.

Place barricades and signs in locations that do not obstruct the sight distance of drivers entering the highway from driveways or side streets.

Do not commence work on the road before sunrise. Do not operate or park any equipment/machinery closer than 30 feet from the traveled roadway after sunset unless authorized by the engineer.

When moving unlicensed equipment on or across any pavement or public highways, protect the pavement from all damage using an acceptable method.

Freeway Lane Closures				
Category of Work	Number of Rdwy Lanes per direction	Peak Times Monday-Friday 6:00 am - 9:00 am 3:30 pm - 7:00 pm Major Events and Major Holidays**	Off Peak Times Monday-Friday 9:00 am - 3:30 pm 7:00 pm - 10:30 pm and Saturday	Lowest Volume Time Monday-Friday 10:30 pm to 6:00 am and Sunday

General Notes

Sheet D



CSJ: 2086-01-048

Sheet 3 B

County: COLLIN

Highway: FM 2551

Placement of CTB & Bridge Beams, Pavement Markings, Full Depth Roadway Repair, Bridge or Similar Demolitions*	5	None	2	3
	4	None	2	3
	3	None	1	2
	2	None	1	2
Adjacent Construction, Lanes for Construction Traffic or Similar Operations	5	None	1	2
	4	None	1	2
	3	None	1	1
	2	None	None	1

\* Provide a traffic control plan where bridge demolition cannot be accomplished with lane closures. Freeway closures will only be done during Lowest Volume Times.

\*\* Major Holidays are defined under Item 1.82 and also include the Easter Weekend.

\*\*\* The Table above is only to be used when traffic counts do not exceed 2000 Vehicles per Lane per Hour. (The capacity of all remaining open lanes must not exceed 2000 Vehicles per Lane per Hour). When traffic counts do or will exceed 2000 Vehicles per Lane per Hour, Director of Construction, Assistant District Engineer or District Engineer approval will be required for lane closures.

Additional lanes may be closed during Off Peak Times or Lowest Times with written permission of the Engineer. Lane Closures during Off Peak Times may be started earlier or be extended later with written permission of the Engineer. Traffic Control Plans with Lane Closures causing backups of 20 minutes or greater in duration will be modified by the Engineer.

Limit lane closures along FM 2551 to the hours between 9:00 am and 3:30 pm. Work in other areas of the project is not restricted to this time frame.

#### Item 618:

The location of conduits and ground boxes are diagrammatic only and may be shifted to accommodate field conditions as directed.

Secure permission and approval from the proper authority prior to cutting into or removing any sidewalks or curbs for installation of this item.

When holes are drilled through concrete structures, use a coring device. Do not use masonry or concrete drills.

Place conduit under existing pavement by an approved boring method. Do not place boring pits closer than 2 feet from the edge of pavement unless otherwise directed. Do not use water

General Notes

Sheet B

CSJ: 2086-01-048

Sheet 3 B

County: COLLIN

Highway: FM 2551

jetting. When conduits are bored, do not exceed 18 inches in the vertical and horizontal tolerances as measured from the intended target point.

Do not use a pneumatically driven device for punching holes beneath the pavement (commonly known as a "mistle").

Furnish and install a non-metallic pull rope in conduit runs in excess of 50 feet.

Use a colored cleaner-primer on all PVC to PVC joints before application of PVC cement.

Furnish and install non-metallic pull ropes in conduit installed for future use and cap using standard weather-light conduit caps, as approved. This work will not be paid for directly, but is subsidiary to this item.

#### Item 1122:

Take all practicable precautions to prevent debris from being discharged into the Waters of Texas or a designated wetland. Install Best Management Practices before demolition begins and maintain them during the demolition. Remove any debris or construction material that escapes containment devices and are discharged into the restricted areas, before the next rain event or within 24 hours of the discharge.

Provide SW3P Signs. Obtain from the Engineer a copy of the project's completed TPDES Storm Water Program Construction Site Notice and signed Contractor Certification Statement. Laminate the sheets and bond with adhesive to 36" X 36" plywood sign blanks. Ensure the sheets remain dry. Apply Type C Blue reflective sheeting as the background and add the text "SW3P" in 5" white lettering, centered at the top. Attach the signs to approved temporary mounts and locate at each of the project limits just inside the right of way line at a readable height or as directed by the Engineer. If the sign cannot be placed outside the clear zone, it must adhere to the TMUTCD. SW3P signs, maintenance, and repostings (for replacement or as needed to ensure readability) will be subsidiary to Item 502.

General Notes

Sheet B

ESTIMATE SUMMARY									
CONTROL SYSTEMS (PAGES)				TOTAL		UNIT		TOTAL	
ITEM	QTY	PRICE	TOTAL	EST	PRICED	DESCRIPTION	UNIT	EST	PRICED
1	1	1,000	1,000	1,000	1,000	CONTROL SYSTEMS (PAGES)	1	1,000	1,000
2	1	1,000	1,000	1,000	1,000	CONTROL SYSTEMS (PAGES)	1	1,000	1,000
3	1	1,000	1,000	1,000	1,000	CONTROL SYSTEMS (PAGES)	1	1,000	1,000
4	1	1,000	1,000	1,000	1,000	CONTROL SYSTEMS (PAGES)	1	1,000	1,000
5	1	1,000	1,000	1,000	1,000	CONTROL SYSTEMS (PAGES)	1	1,000	1,000
6	1	1,000	1,000	1,000	1,000	CONTROL SYSTEMS (PAGES)	1	1,000	1,000
7	1	1,000	1,000	1,000	1,000	CONTROL SYSTEMS (PAGES)	1	1,000	1,000
8	1	1,000	1,000	1,000	1,000	CONTROL SYSTEMS (PAGES)	1	1,000	1,000
9	1	1,000	1,000	1,000	1,000	CONTROL SYSTEMS (PAGES)	1	1,000	1,000
10	1	1,000	1,000	1,000	1,000	CONTROL SYSTEMS (PAGES)	1	1,000	1,000
11	1	1,000	1,000	1,000	1,000	CONTROL SYSTEMS (PAGES)	1	1,000	1,000
12	1	1,000	1,000	1,000	1,000	CONTROL SYSTEMS (PAGES)	1	1,000	1,000
13	1	1,000	1,000	1,000	1,000	CONTROL SYSTEMS (PAGES)	1	1,000	1,000
14	1	1,000	1,000	1,000	1,000	CONTROL SYSTEMS (PAGES)	1	1,000	1,000
15	1	1,000	1,000	1,000	1,000	CONTROL SYSTEMS (PAGES)	1	1,000	1,000
16	1	1,000	1,000	1,000	1,000	CONTROL SYSTEMS (PAGES)	1	1,000	1,000
17	1	1,000	1,000	1,000	1,000	CONTROL SYSTEMS (PAGES)	1	1,000	1,000
18	1	1,000	1,000	1,000	1,000	CONTROL SYSTEMS (PAGES)	1	1,000	1,000
19	1	1,000	1,000	1,000	1,000	CONTROL SYSTEMS (PAGES)	1	1,000	1,000
20	1	1,000	1,000	1,000	1,000	CONTROL SYSTEMS (PAGES)	1	1,000	1,000
21	1	1,000	1,000	1,000	1,000	CONTROL SYSTEMS (PAGES)	1	1,000	1,000
22	1	1,000	1,000	1,000	1,000	CONTROL SYSTEMS (PAGES)	1	1,000	1,000
23	1	1,000	1,000	1,000	1,000	CONTROL SYSTEMS (PAGES)	1	1,000	1,000
24	1	1,000	1,000	1,000	1,000	CONTROL SYSTEMS (PAGES)	1	1,000	1,000
25	1	1,000	1,000	1,000	1,000	CONTROL SYSTEMS (PAGES)	1	1,000	1,000
26	1	1,000	1,000	1,000	1,000	CONTROL SYSTEMS (PAGES)	1	1,000	1,000
27	1	1,000	1,000	1,000	1,000	CONTROL SYSTEMS (PAGES)	1	1,000	1,000
28	1	1,000	1,000	1,000	1,000	CONTROL SYSTEMS (PAGES)	1	1,000	1,000
29	1	1,000	1,000	1,000	1,000	CONTROL SYSTEMS (PAGES)	1	1,000	1,000
30	1	1,000	1,000	1,000	1,000	CONTROL SYSTEMS (PAGES)	1	1,000	1,000
31	1	1,000	1,000	1,000	1,000	CONTROL SYSTEMS (PAGES)	1	1,000	1,000
32	1	1,000	1,000	1,000	1,000	CONTROL SYSTEMS (PAGES)	1	1,000	1,000
33	1	1,000	1,000	1,000	1,000	CONTROL SYSTEMS (PAGES)	1	1,000	1,000
34	1	1,000	1,000	1,000	1,000	CONTROL SYSTEMS (PAGES)	1	1,000	1,000
35	1	1,000	1,000	1,000	1,000	CONTROL SYSTEMS (PAGES)	1	1,000	1,000
36	1	1,000	1,000	1,000	1,000	CONTROL SYSTEMS (PAGES)	1	1,000	1,000
37	1	1,000	1,000	1,000	1,000	CONTROL SYSTEMS (PAGES)	1	1,000	1,000
38	1	1,000	1,000	1,000	1,000	CONTROL SYSTEMS (PAGES)	1	1,000	1,000
39	1	1,000	1,000	1,000	1,000	CONTROL SYSTEMS (PAGES)	1	1,000	1,000
40	1	1,000	1,000	1,000	1,000	CONTROL SYSTEMS (PAGES)	1	1,000	1,000
41	1	1,000	1,000	1,000	1,000	CONTROL SYSTEMS (PAGES)	1	1,000	1,000
42	1	1,000	1,000	1,000	1,000	CONTROL SYSTEMS (PAGES)	1	1,000	1,000
43	1	1,000	1,000	1,000	1,000	CONTROL SYSTEMS (PAGES)	1	1,000	1,000
44	1	1,000	1,000	1,000	1,000	CONTROL SYSTEMS (PAGES)	1	1,000	1,000
45	1	1,000	1,000	1,000	1,000	CONTROL SYSTEMS (PAGES)	1	1,000	1,000
46	1	1,000	1,000	1,000	1,000	CONTROL SYSTEMS (PAGES)	1	1,000	1,000
47	1	1,000	1,000	1,000	1,000	CONTROL SYSTEMS (PAGES)	1	1,000	1,000
48	1	1,000	1,000	1,000	1,000	CONTROL SYSTEMS (PAGES)	1	1,000	1,000
49	1	1,000	1,000	1,000	1,000	CONTROL SYSTEMS (PAGES)	1	1,000	1,000
50	1	1,000	1,000	1,000	1,000	CONTROL SYSTEMS (PAGES)	1	1,000	1,000
51	1	1,000	1,000	1,000	1,000	CONTROL SYSTEMS (PAGES)	1	1,000	1,000
52	1	1,000	1,000	1,000	1,000	CONTROL SYSTEMS (PAGES)	1	1,000	1,000
53	1	1,000	1,000	1,000	1,000	CONTROL SYSTEMS (PAGES)	1	1,000	1,000
54	1	1,000	1,000	1,000	1,000	CONTROL SYSTEMS (PAGES)	1	1,000	1,000
55	1	1,000	1,000	1,000	1,000	CONTROL SYSTEMS (PAGES)	1	1,000	1,000
56	1	1,000	1,000	1,000	1,000	CONTROL SYSTEMS (PAGES)	1	1,000	1,000
57	1	1,000	1,000	1,000	1,000	CONTROL SYSTEMS (PAGES)	1	1,000	1,000
58	1	1,000	1,000	1,000	1,000	CONTROL SYSTEMS (PAGES)	1	1,000	1,000
59	1	1,000	1,000	1,000	1,000	CONTROL SYSTEMS (PAGES)	1	1,000	1,000
60	1	1,000	1,000	1,000	1,000	CONTROL SYSTEMS (PAGES)	1	1,000	1,000
61	1	1,000	1,000	1,000	1,000	CONTROL SYSTEMS (PAGES)	1	1,000	1,000
62	1	1,000	1,000	1,000	1,000	CONTROL SYSTEMS (PAGES)	1	1,000	1,000
63	1	1,000	1,000	1,000	1,000	CONTROL SYSTEMS (PAGES)	1	1,000	1,000
64	1	1,000	1,000	1,000	1,000	CONTROL SYSTEMS (PAGES)	1	1,000	1,000
65	1	1,000	1,000	1,000	1,000	CONTROL SYSTEMS (PAGES)	1	1,000	1,000
66	1	1,000	1,000	1,000	1,000	CONTROL SYSTEMS (PAGES)	1	1,000	1,000
67	1	1,000	1,000	1,000	1,000	CONTROL SYSTEMS (PAGES)	1	1,000	1,000
68	1	1,000	1,000	1,000	1,000	CONTROL SYSTEMS (PAGES)	1	1,000	1,000
69	1	1,000	1,000	1,000	1,000	CONTROL SYSTEMS (PAGES)	1	1,000	1,000
70	1	1,000	1,000	1,000	1,000	CONTROL SYSTEMS (PAGES)	1	1,000	1,000
71	1	1,000	1,000	1,000	1,000	CONTROL SYSTEMS (PAGES)	1	1,000	1,000
72	1	1,000	1,000	1,000	1,000	CONTROL SYSTEMS (PAGES)	1	1,000	1,000
73	1	1,000	1,000	1,000	1,000	CONTROL SYSTEMS (PAGES)	1	1,000	1,000
74	1	1,000	1,000	1,000	1,000	CONTROL SYSTEMS (PAGES)	1	1,000	1,000
75	1	1,000	1,000	1,000	1,000	CONTROL SYSTEMS (PAGES)	1	1,000	1,000
76	1	1,000	1,000	1,000	1,000	CONTROL SYSTEMS (PAGES)	1	1,000	1,000
77	1	1,000	1,000	1,000	1,000	CONTROL SYSTEMS (PAGES)	1	1,000	1,000
78	1	1,000	1,000	1,000	1,000	CONTROL SYSTEMS (PAGES)	1	1,000	1,000
79	1	1,000	1,000	1,000	1,000	CONTROL SYSTEMS (PAGES)	1	1,000	1,000
80	1	1,000	1,000	1,000	1,000	CONTROL SYSTEMS (PAGES)	1	1,000	1,000
81	1	1,000	1,000	1,000	1,000	CONTROL SYSTEMS (PAGES)	1	1,000	1,000
82	1	1,000	1,000	1,000	1,000	CONTROL SYSTEMS (PAGES)	1	1,000	1,000
83	1	1,000	1,000	1,000	1,000	CONTROL SYSTEMS (PAGES)	1	1,000	1,000
84	1	1,000	1,000	1,000	1,000	CONTROL SYSTEMS (PAGES)	1	1,000	1,000
85	1	1,000	1,000	1,000	1,000	CONTROL SYSTEMS (PAGES)	1	1,000	1,000
86	1	1,000	1,000	1,000	1,000	CONTROL SYSTEMS (PAGES)	1	1,000	1,000
87	1	1,000	1,000	1,000	1,000	CONTROL SYSTEMS (PAGES)	1	1,000	1,000
88	1	1,000	1,000	1,000	1,000	CONTROL SYSTEMS (PAGES)	1	1,000	1,000
89	1	1,000	1,000	1,000	1,000	CONTROL SYSTEMS (PAGES)	1	1,000	1,000
90	1	1,000	1,000	1,000	1,000	CONTROL SYSTEMS (PAGES)	1	1,000	1,000
91	1	1,000	1,000	1,000	1,000	CONTROL SYSTEMS (PAGES)	1	1,000	1,000
92	1	1,000	1,000	1,000	1,000	CONTROL SYSTEMS (PAGES)	1	1,000	1,000
93	1	1,000	1,000	1,000	1,000	CONTROL SYSTEMS (PAGES)	1	1,000	1,000
94	1	1,000	1,000	1,000	1,000	CONTROL SYSTEMS (PAGES)	1	1,000	1,000
95	1	1,000	1,000	1,000	1,000	CONTROL SYSTEMS (PAGES)	1	1,000	1,000
96	1	1,000	1,000	1,000	1,000	CONTROL SYSTEMS (PAGES)	1	1,000	1,000
97	1	1,000	1,000	1,000	1,000	CONTROL SYSTEMS (PAGES)	1	1,000	1,000
98	1	1,000	1,000	1,000	1,000	CONTROL SYSTEMS (PAGES)	1	1,000	1,000
99	1	1,000	1,000	1,000	1,000	CONTROL SYSTEMS (PAGES)	1	1,000	1,000
100	1	1,000	1,000	1,000	1,000	CONTROL SYSTEMS (PAGES)	1	1,000	1,000

ESTIMATE & QUANTITY SHEET

EST	COUNTY	COST	INSET
10	COLLIN	100000000	1

ST/COMPRESS

ATTACHMENT A

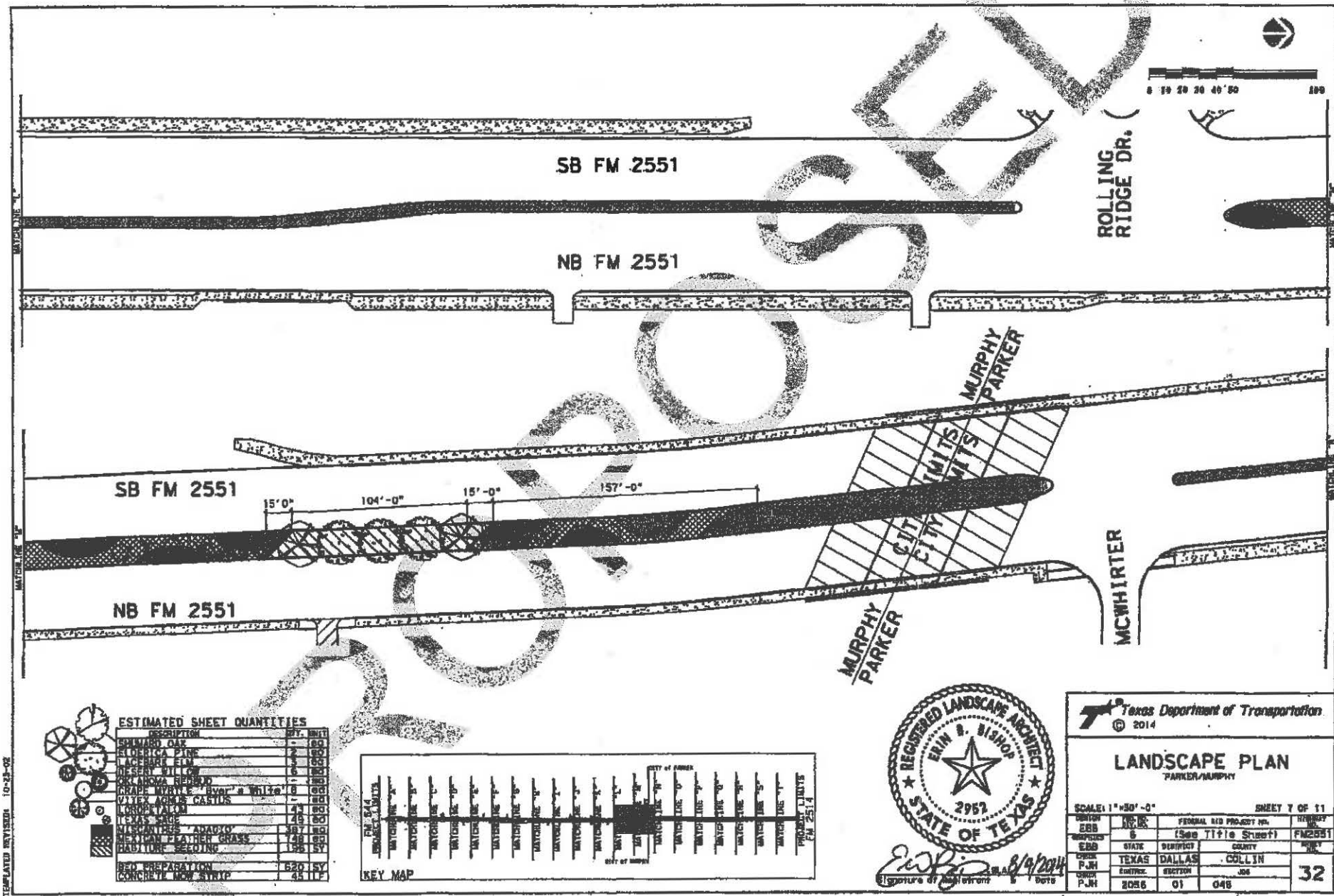

**ESTIMATED SHEET QUANTITIES**

DESCRIPTION	QTY.	UNIT
SHIMMARD OAK	2	BO
ELDERICA PINE	2	BO
NICHOLSON ELM	2	BO
NICHOLSON VILLOW	2	BO
GRAPE VINE "Royal" x White	8	BO
VITEX AGNES CASTUS	1	BO
LODGEPOLE ALUM	43	BO
TEXAS SAGE	45	BO
NICHOLSON ADARDO	39	BO
MEXICAN PLASTER GRASS	748	BO
RADIOLIA SEEDING	125	SY
RED PREPARATION	620	SY
CONCRETE NEW STRIP	45	LF

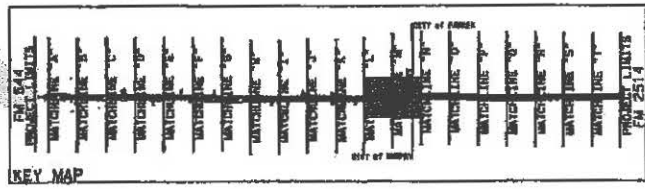

**Texas Department of Transportation**  
© 2014

**LANDSCAPE PLAN**  
PARKER/MURPHY

SCALE: 1"=50'-0" SHEET 7 OF 11

SECTION	NO.	FEDERAL AID PROJECT NO.	THIRTY
SECTION	6	(See Title Sheet)	FM2551
STATE	TEXAS	COUNTY	DALLAS
CITY	P.J.H.	DISTRICT	COLLIN
CONTRACT	2056	SECTION	048

Signature of Architect: *E.S. Bishop* Date: 8/9/2014

32



ATTACHMENT

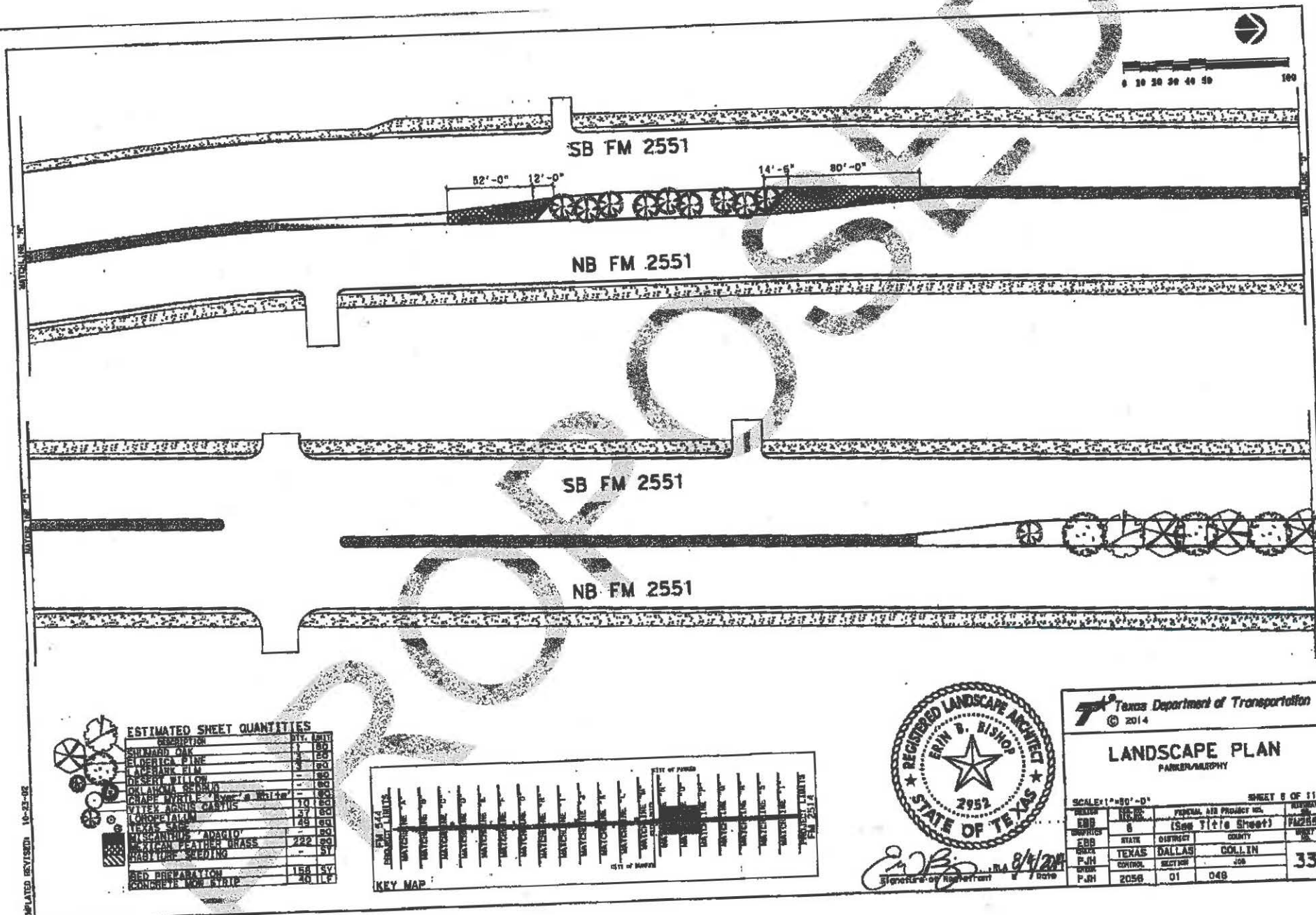

ESTIMATED SHEET QUANTITIES

DESCRIPTION	QTY	UNIT
SHRUB OAK	1	EA
ELDERICA PINE	1	EA
LACINIA PINE	1	EA
DESERT WILLOW	1	EA
OKLAHOMA BERRY	1	EA
CRAB APPLE	1	EA
VITEX AGNES CARTER	10	EA
LOOSELEAF	48	EA
TEXAS SAGE	48	EA
PERFORATED ADAMANT	222	EA
ARTIFICIAL PEATHER GRASS	51	EA
GRASS SEEDING	154	SY
CONCRETE MOW STRIP	20	LF

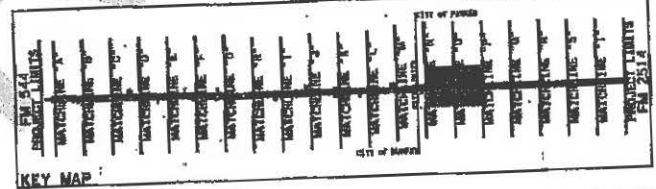

Texas Department of Transportation  
© 2014

**LANDSCAPE PLAN**  
PARKER/MARSHY

SCALE: 1"=80'-0"

SHEET 8 OF 11

DESIGNER	NO. 8	FEDERAL AID PROJECT NO.	PA22851
GRAPHICS	8	(See Title Sheet)	
DATE	STATE	COUNTY	CITY
P.J.H.	TEXAS	DALLAS	GOLLIN
P.J.H.	CONTROL	SECTION	JOB
P.J.H.	2056	01	048

33

[illegible]

 TEXAS Department of Transportation © 2014			
<h1>LANDSCAPE PLAN</h1> <p>PARKER/MURPHY</p>			
SCALE: 1"=50'-0"		SHEET 8 OF 11	
DESIGN EGG	DATE 6	FEDERAL AID PROJECT NO.	EXHIBIT NO.
		(See Title Sheet)	FM255
DRAWN EGG	STATE	DISTRICT	COUNTY
CHECK P.J.H.	TEXAS	DALLAS	COLLIN
CLASS P.J.H.	CONTROL	SECTION	JOB
	2084	01	048
			34



GREGORY LANE



SB FM 2551

NB FM 2551

SB FM 2551

NB FM 2551

**ESTIMATED SHEET QUANTITIES**

DESCRIPTION	MT.	FT.
SHILBARK OAK	1	00
ELDERBARK PINE	1	00
LACEDBARK ELM	1	00
DESERT WILLOW	1	00
OKLAHOMA REDBUD	1	00
SHADE TURTLE "Palm" & "White"	1	00
VITEX AGNUS CASTUS	1	00
LOOSELEAF	1	00
VERA SAGE	1	00
MISCANTHUS "ADAM'S"	1	00
MEXICAN PEPPER GRASS	1	00
RASTAFARI BROOM	1	00
RED PREPARATION	1	00
CONCRETE MED STRIP	1	00

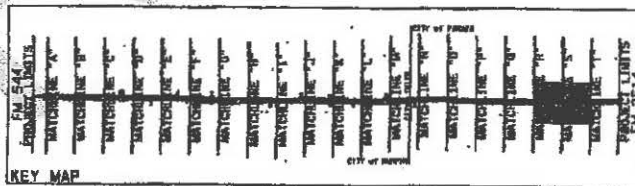

Texas Department of Transportation  
© 2014

**LANDSCAPE PLAN**  
PARKER/MURPHY

SCALE: 1"=50'-0"	SHEET 10 OF 11
DESIGNER: EBB	PROJECT NO.: FM2551
DATE: 6	(See Title Sheet)
STATE: TEXAS	DISTRICT: DALLAS
COUNTY: COLLIN	CITY: COLLEEN
PROJECT NO.: 2086	01 048

35

ATTACHMENT A

UNLATERED REVISION 10-25-02

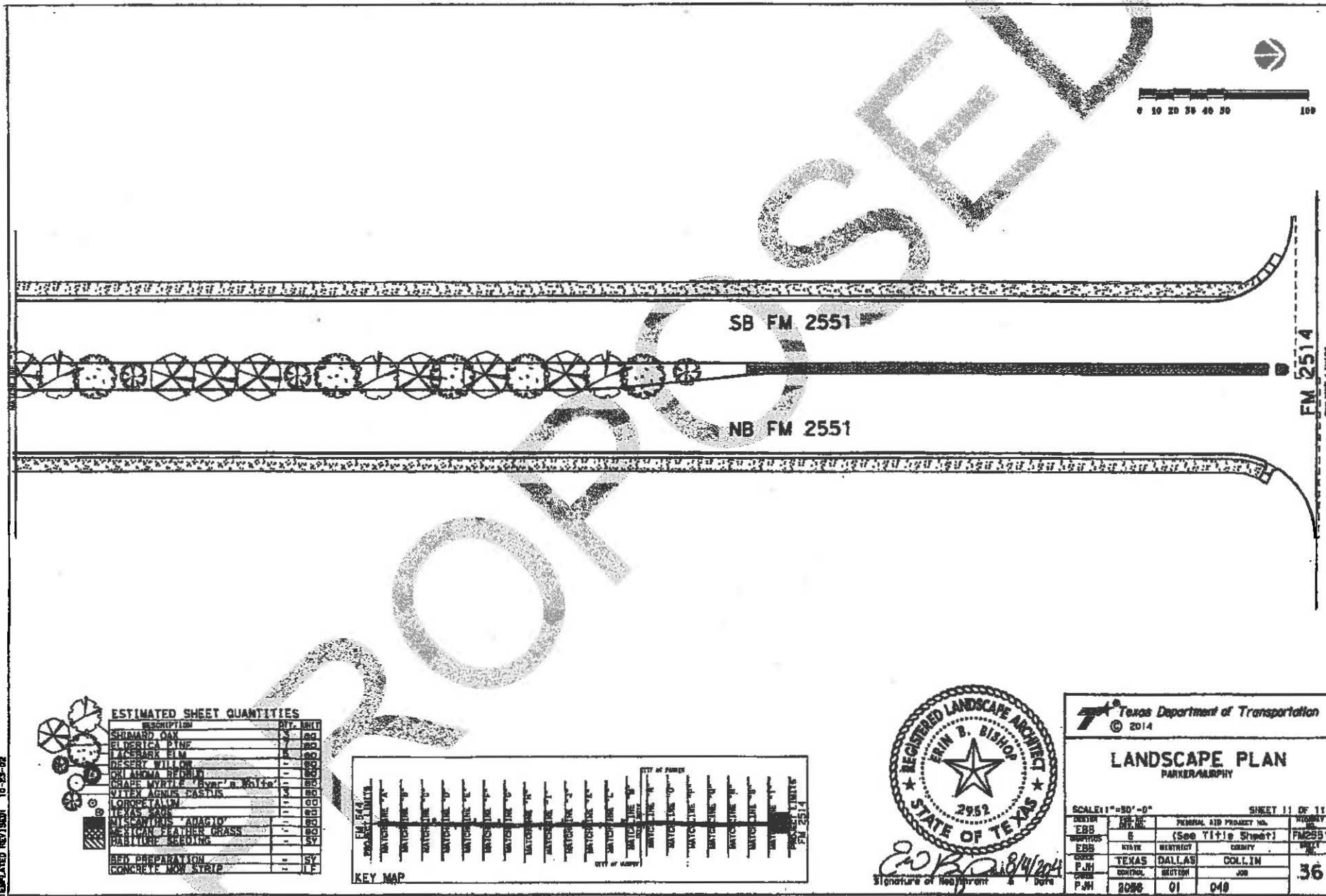

#### ESTIMATED SHEET QUANTITIES

DESCRIPTION	QTY.	UNIT
SHRUB OAK	3	80
ELDERICA PINE	7	80
FLORIDA ELM	1	80
DESERT WILLOW	1	80
OKLAHOMA REDWOOD	1	80
SHADE MYRTLE "Ever n White"	1	80
WITEX AGNUS CASTUS	1	80
LOROPETALUM	1	80
TEXAS MAUI	1	80
DISCONTINUOUS "ARAGIO"	1	80
MEXICAN FEATHER GRASS	1	80
REBOUTER SEEDLING	1	80
BED PREPARATION	1	SY
CONCRETE MON STRIP	1	LF

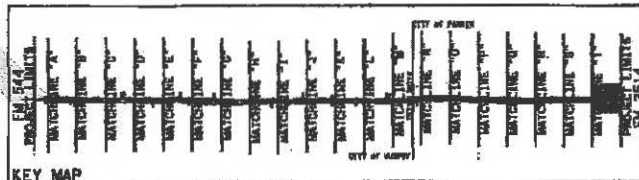

Signature of Neelbrom Date 8/4/2014

Texas Department of Transportation © 2014			
LANDSCAPE PLAN PARKER/MURPHY			
SCALE: 1"=50'-0" SHEET 11 OF 11			
DESIGN EBB	DATE 8/4/2014	FEDERAL AID PROJECT NO. (See Title Sheet)	PROJECT NO. FM2551
DESIGN EBB	STATE TEXAS	DISTRICT DALLAS	COUNTY COLLIN
DESIGN PJM	CONTROL 2058	SECTION 01	JOB 048
DESIGN PJM			36

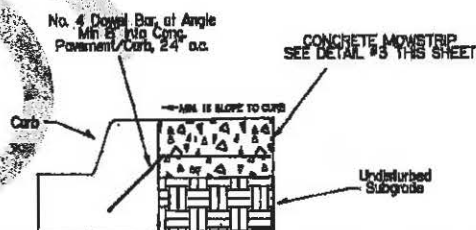
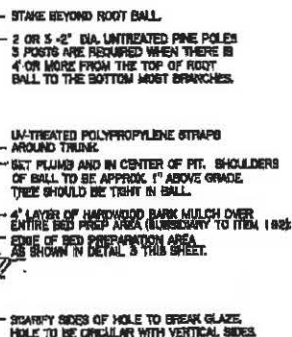
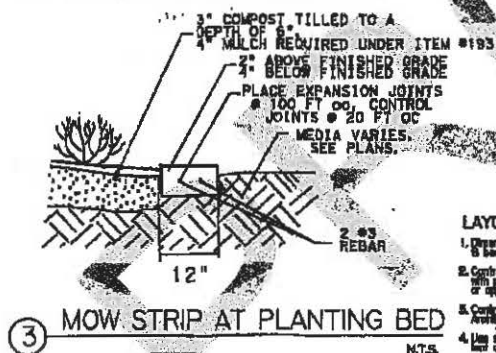
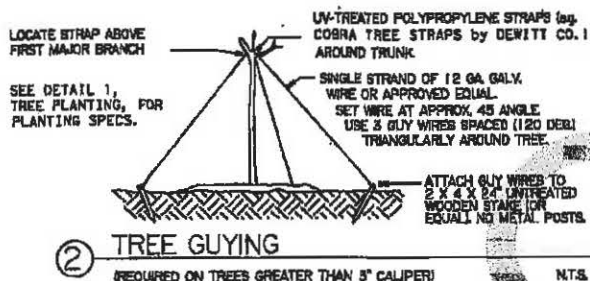

### LAYOUT NOTES:

1. Drawings are shown for general layout guidance; how ship is laid edges must be suitable framing.
2. Contractor shall mark how ship & bed edge locations in field with nails for approval by Landscape Architect before excavating or applying materials for land preparation.
3. Contractor shall have firm work placement approved by Landscape Architect prior to pouring concrete.
4. Lay steel edging Landscape Edging between plant, walkies beds or areas.

[illegible]

• All input modules will be factory tested to standards

GENERAL NOTES:

1. Contractor will be responsible for referencing item 192 of the Texas Standard Specifications for Construction of Highways, Streets and Bridges 2004 for specifications, dimensions, volumes and measurements that have been modified or not shown.
2. All plants will be nursery-grown in containers unless otherwise shown on plans.
3. Rejection of plants will be in accordance with item 192.26b1.
4. Locations of trees, shrubs, and beds will be stated in the field by the Contractor in accordance with item 192.36c1.
5. The Contractor will be responsible for the safe transportation of plants to the project site and their condition upon arrival.
6. Plant materials will not be stored on hard surface or left exposed to the sun.
7. Protect the root balls and water regularly until planting.
8. If plants are left in storage over the weekend or holiday, a means of periodically watering and inspection container moisture will be provided.
9. All plants will be hardy, symmetrical, tight knit, and so trained or favored in development and appearance as to be superior in form, number of branches, and compactness. Plants will be sound, healthy, and vigorous, well branched, densely foliated when in leaf, and will have healthy, well developed root systems.
10. All shrub and tree plantings will be mulched after planting to the depth indicated in the details. Mulch will be shredded hardwood with a minimum 3/8 inch not over 2 1/2 by volume of the particles and dust. Mulch will be free of any plastic, glass, metals, and other contaminants (sticks, stones, clay, or other foreign matter).
11. **PLANTING BED PREPARATION**

#### 1.1. PLANTING BED PREPARATION:

Once bed locations have been approved in the field, apply a glyphosate herbicide within the bed areas to kill existing grasses and weeds. Wait 7-10 days to ensure complete vegetation control. Reapply as necessary before applying compost.

Apply Three inches (3") of General Use Compost to all planting areas and thoroughly till to a depth of six inches (6"). Specification Item 161 Compost - General Use Compost and Herbicide Applications will not be paid for separately but will be considered subsidiary to Item 192 planting bed preparation.



 Texas Department of Transportation  
© 2014

## LANDSCAPE PLANTING DETAILS

SCALE: NOT TO SCALE				FM 256
SECTION	FED. AID PROJECT NO.	HIGHWAY		
EBB	6	US 350		
TOWNSHIP	(See Title Sheet)			
EBB	STATE DISTRICT COUNTY			
SECTION	TEXAS DALLAS COLLIN			
PJH	CONTRACT DISTRICT JOB			
CHUCK	SECTION	37		



ATTACHMENT

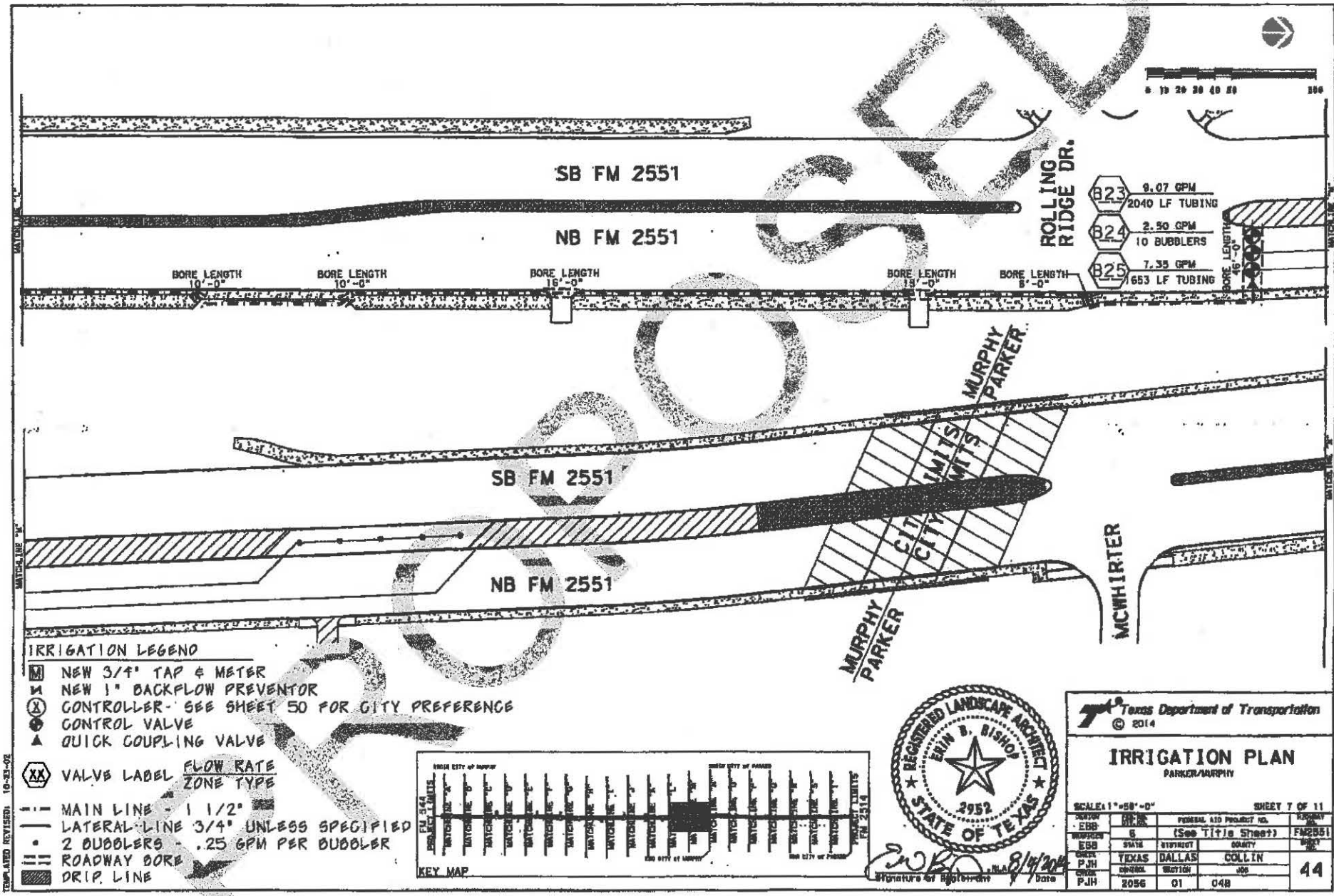

IRRIGATION LEGEND

- [M] NEW 3/4" TAP & METER
- [X] NEW 1" BACKFLOW PREVENTOR
- [X] CONTROLLER - SEE SHEET 50 FOR CITY PREFERENCE
- [V] CONTROL VALVE
- [A] QUICK COUPLING VALVE

[XX] VALVE LABEL FLOW RATE ZONE TYPE

- MAIN LINE - 1 1/2"
- LATERAL LINE 3/4" UNLESS SPECIFIED
- 2 BUBBLERS .25 GPM PER BUBBLER
- ROADWAY BORE
- DRIP LINE

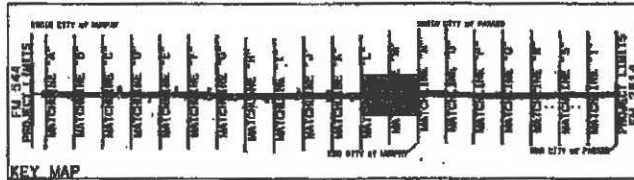

Texas Department of Transportation  
© 2014

**IRRIGATION PLAN**  
PARKER/MURPHY

SCALE: 1"=50'-0" SHEET 7 OF 11

DESIGN	ENG	DATE	8/14/2014	FEDERAL AID PROJECT NO.	FM2551
DRAWN	ENG	(See Title Sheet)			
CHECK	ENG	STATE	TEXAS	COUNTY	DALLAS
CHECK	PJH	CITY	PARKER	SECTION	01
CHECK	PJH	DATE	2056	JOB	048

44



0 10 20 30 40 50 100

SB FM 2551

NB FM 2551

BORE LENGTH  
40'-0"

RANCHVIEW

SB FM 2551

NB FM 2551

BORE LENGTH  
36'-0"

BORE LENGTH  
37'-0"

### IRRIGATION LEGEND

- ☒ NEW 3/4" TAP & METER
- ☒ NEW 1" BACKFLOW PREVENTOR
- ☒ CONTROLLER- SEE SHEET 50 FOR CITY PREFERENCE
- ☒ CONTROL VALVE
- ☒ QUICK COUPLING VALVE

☒ VALVE LABEL FLOW RATE  
ZONE TYPE

- MAIN LINE - 1 1/2"
- LATERAL LINE 3/4" UNLESS SPECIFIED
- 2 BUBBLERS - .25 GPM PER BUBBLER
- == ROADWAY BORE
- == DRIP LINE

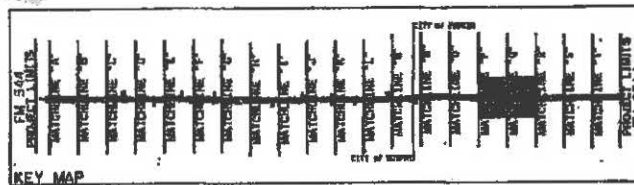

Signature of Registrant: *Erin B. Bishop* Date: 8/4/2014

Texas Department of Transportation  
© 2014

### IRRIGATION PLAN PARKER/MURPHY

SCALE: 1"=50'-0"				SHEET 9 OF 11	
SECTION	DATE	FEDERAL AID PROJECT NO.		HIGHWAY	
EBB	8	(Show 11+00 Station)		FM2551	
SECTION	STATE	DISTRICT	COUNTY	SHEET	
P-JH	TEXAS	DALLAS	COLLIN	46	
CONTRACT	SECTION	JOB			
P-JH	2056	01	D48		

GREGORY LN.

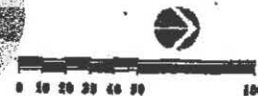

SB FM 2551

NB FM 2551

C5 4.5 GPM  
18 BUBBLERS

BORE LENGTH  
52'-0"

SB FM 2551

NB FM 2551

C6 3.00 GPM  
12 BUBBLERS

BORE LENGTH  
50'-0"

BORE LENGTH  
50'-0"

C7 12.5 GPM  
50 BUBBLERS

BORE LENGTH  
38'-0"

IRRIGATION LEGEND

- [M] NEW 3/4" TAP & METER
- [I] NEW 1" BACKFLOW PREVENTOR
- [X] CONTROLLER- SEE SHEET 50 FOR CITY PREFERENCE
- [C] CONTROL VALVE
- [A] QUICK COUPLING VALVE

[XX] VALVE LABEL FLOW RATE  
ZONE TYPE

- MAIN LINE - 1 1/2"
- - - LATERAL LINE 3/4" UNLESS SPECIFIED
- 2 BUBBLERS - .25 GPM PER BUBBLER
- == ROADWAY BORE
- DRIP LINE

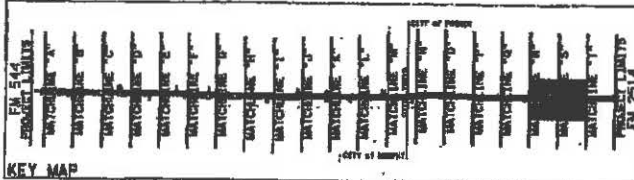

Texas Department of Transportation © 2014			
<b>IRRIGATION PLAN</b> PARKER/MURPHY			
SCALE: 1"=50'-0" SHEET 10 OF 11			
DESIGN EBB	DATE 6/16/14	FEDERAL AID PROJECT NO. (See Title Sheet)	ROUTE FM 2551
TRANSFERS EBS	STATE TEXAS	DISTRICT DALLAS	COUNTY COLLIN
ENGINEER P.J.N.	SECTION 01	SHEET 048	47

ATTACHMENT





SB FM 2551

NB FM 2551

FM 2514  
PROJECT LIMITS

CONDUIT RUN				
Run No.	Conduit Size/Type (LF)	Electrical CDR (EA)		
		No. 8 Bare Wire	No. 12 XHHW Wire	No. 6 XHHW Wire
1	25	-	-	-
2	10	1	2	-
3	25	-	-	-
4	10	1	2	-
TOTAL	70	20	40	-

ELECTRICAL SERVICES DATA

Elec. Service No.	Sheet No.	Electrical Service Description (see SD (6) - (8))	Service Conduit Size	Service Conductors No./Size	Safety Switch Amps	Main Ckt. Blk. Pole/Amps	Two-Pole Contactor Amps	Panel/Loadcenter Amp Rating	Circuit No.	Branch Ckt. Blk. Pole/Amps	Branch Circuit Amps	KVA Load
1	38	RECESSED TY 12(120/240/360/480)ALN(75)(0)	1 1/4"	-	N/A	2P/80	N/A	100	A	1P20	5	0.8
2	41	RECESSED TY 12(120/240/360/480)ALN(75)(0)	1 1/4"	-	N/A	2P/80	N/A	100	B	1P20	5	0.8

\* FURNISHED AND INSTALLED BY ONCOR

IRRIGATION LEGEND

- NEW 3/4" TAP & METER
- NEW 1" BACKFLOW PREVENTOR
- CONTROLLER- SEE SHEET 50 FOR CITY PREFERENCE
- CONTROL VALVE
- QUICK COUPLING VALVE
- VALVE LABEL FLOW-RATE ZONE TYPE
- MAIN LINE - 1 1/2" SD
- LATERAL LINE 3/4" UNLESS SPECIFIED
- 2 BUBBLERS - .25 GPM PER BUBBLER
- ROADWAY BORE
- DRIP LINE

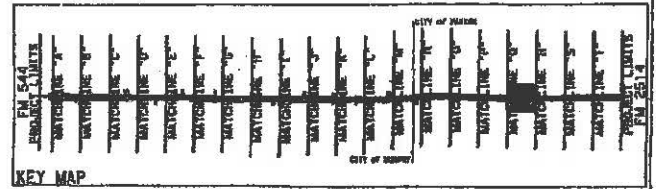

Alan P. McNeil  
8/8/14



Signature of Landscape Architect  
Date 8/04/14

Texas Department of Transportation © 2014			
IRRIGATION PLAN PARKER/MURPHY			
SCALE: 1"=80'-0"		SHEET 11 OF 11	
DESIGN EGB	DATE 8/14/14	PERSONAL AND PROJECT NO. (See Title Sheet) FM2551	
DRAWN PJM	STATE TEXAS	DISTRICT DALLAS	COUNTY COLLIN
CHECK PJM	CONTROL 2056	DISTRICT 01	JOB 048

TYPICAL REVISION 10-25-02

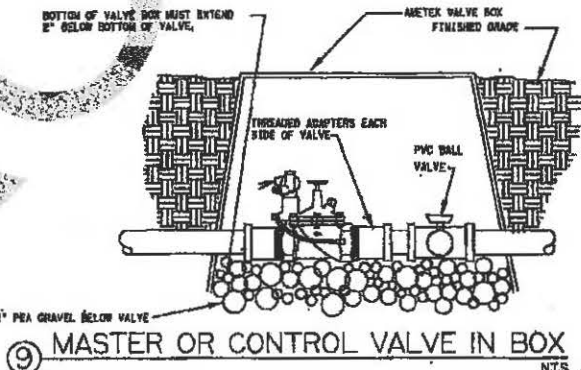
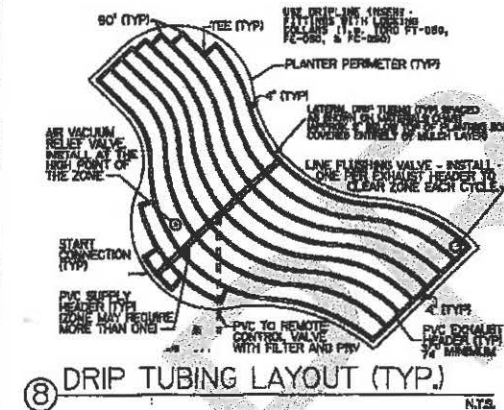
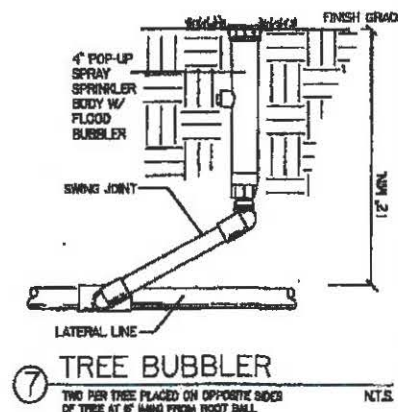
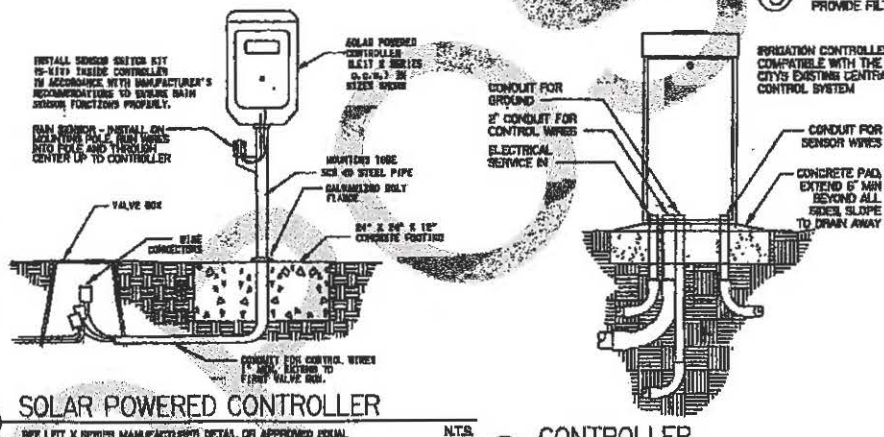
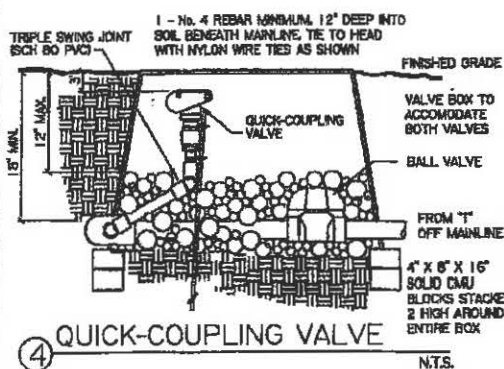
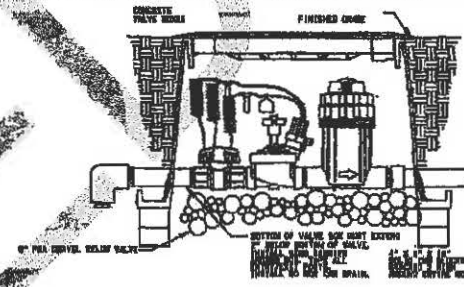
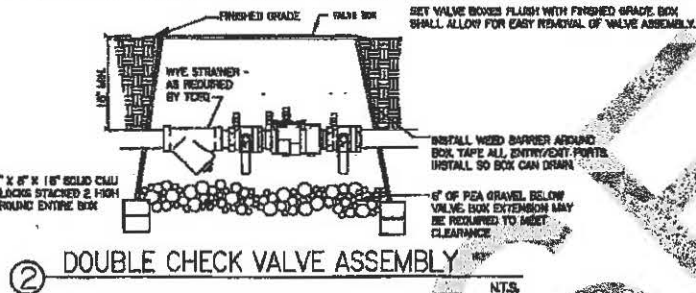
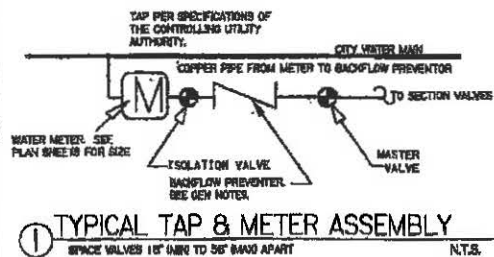

Texas Department of Transportation  
© 2014

# IRRIGATION DETAILS PARKER/MURPHY

SCALE: NTS	SHEET 1 OF 1			
DESIGN	DATE	FEDERAL AID PROJECT NO.	STATION	BY
DRP	8	(See Title Sheet)	SH 2551	MM
DRP	8	DISTRICT	COUNTY	DATE
CITY	PJH	TEXAS	DALLAS	COLLIN
SECTION	PJH	2056	01	048



[illegible][illegible][illegible]

DESCRIPTION	# EXAMPLE OR EQUAL	SIZE	APPROXIMATE QUANTITIES FOR INFORMATIONAL PURPOSE ONLY
WATER METER	PER LOCAL CODE	3/4" INCH	3 IRRIGATION ZONES DESIGNED BASED ON MINIMUM 50 PSI STATIC PRESSURE. PROVIDE LOW PRESSURE METER PRIOR TO STATIC SYSTEM IN THE EVENT STATIC PRESSURE IS LESS THAN 50 PSI.
DRIP TUBING	NETAFIM OR APPROVED EQUAL		10' QS
TREE BUBBLERS	RAINBIRD 1804 BODY W/ 1401 BUBBLER HUNTER PROS-54 BODY W/ PCH-35 BUBBLER	0.25 GPM/BUBBLER, 2 PER TREE	PRO. PLACE SPRINKLER BODIES DIRECTLY OPPOSITE EACH OTHER APPROXIMATELY 6" OUTSIDE ROOT BALL
MASTER VALVE	RAINBIRD PEB SERIES	RAINBIRD PEB SERIES	3
BALL VALVE	SPEARS OR EQUAL	SAME AS LINE SIZE	37
BACKFLOW PREVENTER	FEWCO 150 (OR PER LOCAL CODE)	1 INCH	3
IRRIGATION CONTROLLERS	MURPHY CONTROLLERS AND WALN MASTER SAME  PARKER CONTROLLER C LEIT X SERIES		2  1 - SHALL INCLUDE 7 QC LATCHING SOLENOIDS (1 PER VALVE)
QUICK COUPLING VALVE	RAINBIRD 44-RC	3/4" INCH	18, PROVIDE 8 QUICK COUPLING KEYS-TO ENGINEER.
IRRIGATION CONTROL VALVES	RAINBIRD PER SERIES	1" INCH	37, PROVIDE 7 QC LATCHING SOLENOIDS FOR VALVES
COPPER PIPE Extends from meter to first side of master valve.	TYPE "K"	1 1/2" INCH	INSTALL BETWEEN METER AND BACKFLOW PREVENTOR
PVC SCH 40 CONDUIT Accessories coated with slip type solvent welded joints		4 INCH (FOR PIPE)	POID for under 11m (11.8, see note 8, CONSTRUCTION METHODS on this sheet.
PVC CLASS 200 MAINLINE Pressure rated with twin gasket couplings and fittings or slip type solvent welded joints		1 1/2" INCH	15, 374 LF TOTAL
PVC CLASS 200 LATERALS AND HEADERS		AS INDICATED ON PLANS	
ABOVE GROUND PIPE INCLUDING BURIED RISERS AND SLIP-JOINT COMPONENTS shall be PVC SCH 80 pipe rated for direct sunlight exposure			AS NEEDED
FITTINGS All fittings incorporated into system shall be of the same type, size and glass material as the pipe			AS NEEDED
CONTROL WIRE All low voltage control wire shall be color coded. Wire sizes shall conform to the controller manufacturer specifications for maximum distance for specific wire sizes. All wire shall be specifically manufactured for direct burial. All wire terminations and splices shall be made in ground boxes. The splices shall be completely waterproof and shall be completely encapsulated within a Top King Black Splice Connector enclosure or an approved equal.		14 GA.	PROVIDE WIRE COIL EVERY 100 FEET TO ALLOW FOR EXPANSION.
SOLVENT CEMENT Solvent cements shall be the type recommended by the pipe manufacturer			DO NOT USE BLUE CEMENT. USE A COLORED PRIMER.
VALVE BOXES Boxes for section valves, below-ground backflow preventors, and quick coupling valves shall be as shown on detail sheet		BOX SIZE SHALL BE MIN. 10" AND ALLOW FOR EASY REMOVAL OF VALVE, ETC.	QUANTITY AS REQUIRED FOR SECTION VALVES, BELOW GROUND BACKFLOW PREVENTORS, QUICK COUPLING VALVES AND ANY ACCESSORIES. PROVIDE CONCRETE OR GRASS COVER PLATE AROUND BOXES TO REDUCE SITUATION TAPES FABRIC IN PLACE AROUND ENTRY POINTS.
VALVE BOX RISERS	CONCRETE MASONRY UNIT (CMU) BLOCKS STACKED 8" HIGH AS SHOWN IN DETAILS.	4" X 8" X 16"	QUANTITY AS REQUIRED FOR SECTION VALVES, BELOW GROUND BACKFLOW PREVENTORS, QUICK COUPLING VALVES AND ANY ACCESSORIES

\* REFERENCE TO MANUFACTURER'S TRADE NAME OR CATALOG NUMBER IS FOR THE PURPOSE OF IDENTIFICATION ONLY. CONTRACTOR SHALL BE PERMITTED TO FURNISH LIKE MATERIALS OF OTHER MANUFACTURERS PROVIDED THEY ARE OF EQUAL QUALITY AND COMPLY WITH SPECIFICATIONS FOR THIS PROJECT AND ARE APPROVED BY THE ENGINEER.



8/4/2014

# IRRIGATION GENERAL NOTES & MATERIAL SPECIFICATIONS

PARKER/MURPHY

SHEET 1 OF

EBB	6	FEDERAL AID PROJECT NO.		HIGHWAY NO.
CHUCK	(See Title Sheet)			
PJH	STATE	DISTRICT	COUNTY	FM 25
CHUCK	TEXAS	DALLAS	COLLIN	
PJH	CONTROL	SECTION	JOB	50
	2058	01	048	

40-66-01 4031.148 U.S.A. 1941



## Council Agenda Item

Budget Account Code:	Meeting Date: April 21, 2015
Budgeted Amount:	Department/ Requestor: Public Works/ City Administrator Flanigan
Fund Balance-before expenditure:	Prepared by: City Administrator Flanigan
Estimated Cost:	Date Prepared: April 16, 2015
Exhibits:	<ol style="list-style-type: none"> <li>1. City Engineer Review Letter</li> <li>2. A&amp;M Response Letter</li> <li>3. Proposed Resolution</li> <li>4. Bid Tabulations</li> </ol>

### AGENDA SUBJECT

CONSIDERATION AND/OR ANY APPROPRIATE ACTION ON RESOLUTION 2015-474 APPROVING BIDS FOR ESTATE LANE PROJECT. [FLANIGAN]

### SUMMARY

### POSSIBLE ACTION

Approve, Table, Deny

Inter – Office Use			
Approved by:			
Department Head/ Requestor:		Date:	
City Attorney:		Date:	
City Administrator:	<i>Tiffany Flanigan</i>	Date:	4/17/15

**BIRKHOFF, HENDRICKS & CARTER, L.L.P.**  
**PROFESSIONAL ENGINEERS**

11910 Greenville Ave., Suite 600

Dallas, Texas 75243

Fax (214) 461-8390

Phone (214) 361-7900

JOHN W. BIRKHOFF, P.E.  
GARY C. HENDRICKS, P.E.  
JOE R. CARTER, P.E.  
MATT HICKEY, P.E.  
ANDREW MATA, JR., P.E.  
JOSEPH T. GRAJEWSKI, III, P.E.  
DEREK B. CHANEY, P.E.  
CRAIG M. KERKHOFF, P.E.

April 16, 2015

Mr. Jeff Flanigan  
City Administrator  
City of Parker  
5700 E. Parker Rd.  
Parker, Texas 75002

Re: Estate Lane Roadway Improvements

Dear Mr. Flanigan:

We have checked the bids received at 1:30 p.m., Tuesday, March 31, 2015 for the Estate Lane Roadway Improvement project. We are enclosing six (6) copies of the Bid Summary and Itemized Bid Tabulation.

A&M Construction & Utilities, Inc. of Rowlett, Texas submitted the lowest Bid in the amount of \$267,347.60. However, the bid instructions require the bidder to establish the unit cost of each bid item both numerically and in words and in the event of a discrepancy the written words of the unit cost will govern. In this bid, the bidder consistently wrote the extended total of the bid item in the space provided for the written words of the unit price. Also, Bid Item No. 26 for relocation of the waterline, if required, had the total unit cost in numeric and written all the same. Backing into the unit cost establishes a reasonable cost for an item that may not be required. The Contractor has provided letters clarifying both items. The council can waive these formalities and utilize the unit cost written numerically and adjust Bid Item No. 26 to arrive at the low bid of \$267,347.60. We recommend this option to the City.

In the event the City chooses not to waive the formality, then McMahon Contracting, L.P. of Grand Prairie, Texas becomes the low bidder with a bid amount of \$350,727.77.

Accordingly, based on the information we have available to us, we recommend that the City waive the formalities outlined above and accept the bid from A&M Construction & Utilities, Inc., and award them a construction contract in the amount of \$267,347.60.

We are available to discuss our recommendation further at your convenience.

Sincerely,

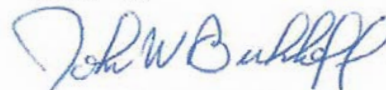

John W. Birkhoff, P.E.

Enclosures



4950 Grisham Dr. Rowlett, TX 75088  
972-412-0255 972-463-0736

April 14, 2015

John Birkhoff  
BIRKHOFF, HENDRICKS & CARTER, L.L.P.  
1910 Greenville Ave.  
Ste. 600  
Dallas, TX 75243

RE: Estate Lane Roadway Improvements  
Item 26 – cost of waterline relocation  
City of Parker

The intended extended bid cost for Item 26 (waterline relocation) for the above referenced project was \$6,000.

We are requesting that the City waive the formality and accept the written extended total of \$6,000 as our bid for Item 26.

Sincerely,

A handwritten signature in blue ink, appearing to read "Rick Thorn", is placed over a light blue rectangular background.

Rick Thorn, VP Operations  
A&M Construction and Utilities, INC.



4950 Grisham Dr. Rowlett, TX 75088  
972-412-0255 972-463-0736

April 13, 2015

John Birkhoff  
BIRKHOFF, HENDRICKS & CARTER, L.L.P.  
1910 Greenville Ave.  
Ste. 600  
Dallas, TX 75243

RE: Estate Lane Roadway Improvements  
Intended bid \$267,347.60  
City of Parker

Due to a clerical area in our office, there was a conflict between the written unit cost and written cost in figures. The cost written in figures represents the intention of our bid.

We are requesting that the City waive the formality and accept the written figures as our bid.

Sincerely,

A handwritten signature in blue ink, appearing to read "Rick Thorn", is written over a light blue circular stamp.

Rick Thorn, VP Operations  
A&M Construction and Utilities, INC.

**CITY OF PARKER, TEXAS**  
**Estate Lane Roadway Improvements**  
**(237 Linear Feet)**

**BID SUMMARY**

**Bids Received at 1:30 p.m., Tuesday, March 31, 2015**

<b><u>Contractor</u></b>	<b><u>Total Amount Bid</u></b>
1. A&M Construction & Utilities, Inc. 4950 Grisham Dr. Rowlett, Texas 75088	<u>\$ 267,347.60</u>
2. McMahon Contracting, L.P. 3019 Roy Orr Blvd. Grand Prairie, Texas 75050	<u>\$ 350,727.77</u>
3. G.Rod Construction, LLC 1204 Old Base Road Aurora, Texas 76078	<u>\$ 373,480.00</u>
4. Pavecon Public Works, LP 3022 Roy Orr Blvd. Grand Prairie, Texas 75050	<u>\$ 412,917.43</u>
5. Jeske Construction Co. P.O. Box 59025 Dallas, Texas 75229	<u>\$ 419,726.50</u>
6. XIT Paving & Construction, Inc. 3934 S. Hwy. 287 Waxahachie, Texas 75165	<u>\$ 424,413.50</u>
7. Lone Star Civil Construction, Inc. 4320 Windsor Centre Trail, #500 Flower Mound, Texas 75028	<u>\$ 442,495.00</u>
8. Ed Bell Construction Company 10605 Harry Hines (PO Box 540787) Dallas, Texas 75354-0787	<u>\$ 569,223.00</u>



TABULATION OF BIDS				BID OF		BID OF		BID OF		BID OF	
<b>Project:</b> CITY OF PARKER, TEXAS Estate Lane Roadway Improvements (237 Linear Feet)				<b>Date:</b> March 31, 2015		<b>BID OF</b> A&M Construction & Utilities, Inc. 4950 Grisham Dr. Rowlett, Texas 75088		<b>BID OF</b> McMahon Contracting, L.P. 3019 Roy Orr Blvd. Grand Prairie, Texas 75050		<b>BID OF</b> G.Rod Construction, LLC 1204 Old Base Road Aurora, Texas 76078	
<b>BIRKHOFF, HENDRICKS &amp; CARTER, L.L.P.</b> PROFESSIONAL ENGINEERS Dallas, Texas				<b>BID OF</b> Pavecon Public Works, LP 3022 Roy Orr Blvd. Grand Prairie, Texas 75050							
Item No.	Approximate Quantities	Unit	Description	Unit Bid Price	Extension	Unit Bid Price	Extension	Unit Bid Price	Extension	Unit Bid Price	Extension
1	24	Ea	For Tree Removal, including Root Removal	\$400.00	\$ 9,600.00	\$767.56	\$ 18,421.44	\$300.00	\$ 7,200.00	\$2,000.00	\$ 48,000.00
2	215	L.F.	For Undercut Street Header	\$6.00	\$ 1,290.00	\$17.01	\$ 3,657.15	\$10.00	\$ 2,150.00	\$20.21	\$ 4,345.15
3	83	L.F.	For Full Depth Saw Cut	\$8.20	\$ 680.60	\$8.05	\$ 668.15	\$6.00	\$ 498.00	\$9.33	\$ 774.39
4	656	S.Y.	Remove & Dispose of Concrete Pavement, including Curb and Gutter	\$30.00	\$ 19,680.00	\$6.94	\$ 4,552.64	\$15.00	\$ 9,840.00	\$17.75	\$ 11,644.00
5	1	L.S.	Remove & Dispose of Existing 84-Inch RCP	\$4,000.00	\$ 4,000.00	\$2,270.00	\$ 2,270.00	\$2,000.00	\$ 2,000.00	\$4,108.44	\$ 4,108.44
6	1	L.S.	Remove & Dispose of Existing 48-Inch RCP	\$3,500.00	\$ 3,500.00	\$4,541.72	\$ 4,541.72	\$3,000.00	\$ 3,000.00	\$3,947.20	\$ 3,947.20
7	2	Ea.	Remove & Dispose of Existing Headwalls	\$5,800.00	\$ 11,600.00	\$12,054.20	\$ 24,108.40	\$4,000.00	\$ 8,000.00	\$3,947.20	\$ 7,894.40
8	920	C.Y.	For Embankment	\$9.00	\$ 8,280.00	\$16.48	\$ 15,161.60	\$20.00	\$ 18,400.00	\$26.19	\$ 24,094.80
9	750	C.Y.	For Unclassified Excavation	\$16.50	\$ 12,375.00	\$22.09	\$ 16,567.50	\$16.00	\$ 12,000.00	\$24.36	\$ 18,270.00
10	54	C.Y.	Furnish, Install & Remove 8-Inch Flex Base (Temporary Roadway)	\$130.00	\$ 7,020.00	\$105.83	\$ 5,714.82	\$200.00	\$ 10,800.00	\$128.59	\$ 6,943.86
11	240	S.Y.	Furnish, Install & Remove 2-Inch HMA (Temporary Roadway)	\$40.00	\$ 9,600.00	\$30.94	\$ 7,425.60	\$30.00	\$ 7,200.00	\$32.33	\$ 7,759.20
12	777	S.Y.	For 6-Inch Compacted Subgrade	\$5.00	\$ 3,885.00	\$3.51	\$ 2,727.27	\$5.00	\$ 3,885.00	\$5.38	\$ 4,180.26
13	725	S.Y.	For 8-Inch Concrete Pavement with 6-INCH Monolithic Curb	\$55.00	\$ 39,875.00	\$46.80	\$ 33,930.00	\$55.00	\$ 39,875.00	\$68.27	\$ 49,495.75
14	104	L.F.	For 8' x 6' Precast Box Culvert, including Embedment	\$620.00	\$ 64,480.00	\$595.18	\$ 61,898.72	\$970.00	\$ 100,880.00	\$948.33	\$ 98,626.32
15	1	Ea.	For Type PW Headwall (11-Feet) Tall	\$20,000.00	\$ 20,000.00	\$37,337.32	\$ 37,337.32	\$52,000.00	\$ 52,000.00	\$36,346.77	\$ 36,346.77
16	1	Ea.	For Type PW Headwall (9½-Feet) Tall	\$15,000.00	\$ 15,000.00	\$31,948.80	\$ 31,948.80	\$32,000.00	\$ 32,000.00	\$30,628.64	\$ 30,628.64
17	163	L.F.	For TxDOT Type C221 with Rail	\$70.00	\$ 11,410.00	\$139.93	\$ 22,808.59	\$150.00	\$ 24,450.00	\$61.34	\$ 9,998.42
18	102	L.F.	Furnish, Install, Maintain & Remove TxDOT MBGR (Temporary Rail)	\$30.00	\$ 3,060.00	\$34.50	\$ 3,519.00	\$32.00	\$ 3,264.00	\$53.04	\$ 5,410.08
19	0	Acre	Furnish, Install & Maintain Block Sod	\$22,000.00	\$ 7,700.00	\$19,550.00	\$ 6,842.50	\$25,000.00	\$ 8,750.00	\$29,505.00	\$ 10,326.75
20	1	L.S.	Furnish, Install, Maintain & Remove Traffic Control Devices	\$2,500.00	\$ 2,500.00	\$25,192.10	\$ 25,192.10	\$3,500.00	\$ 3,500.00	\$4,440.00	\$ 4,440.00
21	1	L.S.	Furnish Storm Water Pollution Prevention Plan	\$1,500.00	\$ 1,500.00	\$1,380.00	\$ 1,380.00	\$1,400.00	\$ 1,400.00	\$2,470.00	\$ 2,470.00
22	1	L.S.	Furnish Trench Safety Plan	\$1,800.00	\$ 1,800.00	\$805.00	\$ 805.00	\$360.00	\$ 360.00	\$726.00	\$ 726.00
23	104	L.F.	Implement Trench Safety Plan	\$3.00	\$ 312.00	\$6.30	\$ 655.20	\$7.00	\$ 728.00	\$31.75	\$ 3,302.00
24	1	L.S.	Furnish, Install, Maintain & Remove Erosion Control Devices	\$200.00	\$ 200.00	\$1,604.25	\$ 1,604.25	\$1,800.00	\$ 1,800.00	\$2,500.00	\$ 2,500.00
25	1	L.S.	For Supporting Existing 6-Inch Waterline and Cable TV Cable during Construction of Culvert and Headwall	\$2,000.00	\$ 2,000.00	\$4,250.00	\$ 4,250.00	\$4,500.00	\$ 4,500.00	\$6,900.00	\$ 6,900.00
26	250	L.F.	For Replacement of 6-Inch Waterline Behind Proposed Back of Curb and Over Culvert Pipe, if required and directed by the City in Writing	\$24.00	\$ 6,000.00	\$50.96	\$ 12,740.00	\$60.00	\$ 15,000.00	\$39.14	\$ 9,785.00
<b>TOTAL AMOUNT BID (Items 1 Through 26)</b>					<b>\$ 267,347.60</b>		<b>\$ 350,727.77</b>		<b>\$ 373,480.00</b>		<b>\$ 412,917.43</b>

TABULATION OF BIDS				BID OF		BID OF		BID OF		BID OF			
Date: <u>March 31, 2015</u>													
Project: <u>CITY OF PARKER, TEXAS</u> <u>Estate Lane Roadway Improvements</u> <u>(237 Linear Feet)</u>				<b>BIRKHOFF, HENDRICKS &amp; CARTER, L.L.P.</b> PROFESSIONAL ENGINEERS Dallas, Texas		Jeske Construction Co. P.O. Box 59025 Dallas, Texas 75229		XIT Paving & Construction, Inc. 3934 S. Hwy 287 Waxahachie, Texas 75165		Lone Star Civil Construction, Inc. 4320 Windsor Centre Trail, #500 Flower Mound, Texas 75028		Ed Bell Construction Company 10605 Harry Hines (PO Box 540787) Dallas, Texas 75354-0787	
Item No.	Approximate Quantities	Unit	Description	Unit Bid Price	Extension	Unit Bid Price	Extension	Unit Bid Price	Extension	Unit Bid Price	Extension		
1	24	Ea.	For Tree Removal, including Root Removal	\$380.00	\$ 9,120.00	\$1,000.00	\$ 24,000.00	\$825.00	\$ 19,800.00	\$1,000.00	\$ 24,000.00		
2	215	L.F.	For Undercut Street Header	\$8.00	\$ 1,720.00	\$10.00	\$ 2,150.00	\$25.00	\$ 5,375.00	\$30.00	\$ 6,450.00		
3	83	L.F.	For Full Depth Saw Cut	\$5.00	\$ 415.00	\$5.00	\$ 415.00	\$35.00	\$ 2,905.00	\$13.00	\$ 1,079.00		
4	656	S.Y.	Remove & Dispose of Concrete Pavement, including Curb and Gutter	\$19.00	\$ 12,464.00	\$18.00	\$ 11,808.00	\$23.00	\$ 15,088.00	\$20.00	\$ 13,120.00		
5	1	L.S.	Remove & Dispose of Existing 84-Inch RCP	\$2,800.00	\$ 2,800.00	\$5,000.00	\$ 5,000.00	\$7,000.00	\$ 7,000.00	\$5,500.00	\$ 5,500.00		
6	1	L.S.	Remove & Dispose of Existing 48-Inch RCP	\$3,000.00	\$ 3,000.00	\$4,000.00	\$ 4,000.00	\$7,000.00	\$ 7,000.00	\$3,000.00	\$ 3,000.00		
7	2	Ea.	Remove & Dispose of Existing Headwalls	\$2,500.00	\$ 5,000.00	\$8,000.00	\$ 16,000.00	\$4,500.00	\$ 9,000.00	\$8,000.00	\$ 16,000.00		
8	920	C.Y.	For Embankment	\$18.00	\$ 16,560.00	\$30.00	\$ 27,600.00	\$27.00	\$ 24,840.00	\$30.00	\$ 27,600.00		
9	750	C.Y.	For Unclassified Excavation	\$16.00	\$ 12,000.00	\$25.00	\$ 18,750.00	\$27.00	\$ 20,250.00	\$20.00	\$ 15,000.00		
10	54	C.Y.	Furnish, Install & Remove 8-Inch Flex Base (Temporary Roadway)	\$98.00	\$ 5,292.00	\$110.00	\$ 5,940.00	\$155.00	\$ 8,370.00	\$75.00	\$ 4,050.00		
11	240	S.Y.	Furnish, Install & Remove 2-Inch HMAC (Temporary Roadway)	\$40.00	\$ 9,600.00	\$40.00	\$ 9,600.00	\$40.00	\$ 9,600.00	\$50.00	\$ 12,000.00		
12	777	S.Y.	For 6-Inch Compacted Subgrade	\$3.00	\$ 2,331.00	\$6.50	\$ 5,050.50	\$15.00	\$ 11,655.00	\$5.00	\$ 3,885.00		
13	725	S.Y.	For 8-Inch Concrete Pavement with 6-INCH Monolithic Curb	\$65.00	\$ 47,125.00	\$60.00	\$ 43,500.00	\$75.00	\$ 54,375.00	\$115.00	\$ 83,375.00		
14	104	L.F.	For 8' x 6' Precast Box Culvert, including Embedment	\$990.00	\$ 102,960.00	\$900.00	\$ 93,600.00	\$650.00	\$ 67,600.00	\$960.00	\$ 99,840.00		
15	1	Ea.	For Type PW Headwall (11'-Feet) Tall	\$65,400.00	\$ 65,400.00	\$40,000.00	\$ 40,000.00	\$50,000.00	\$ 50,000.00	\$90,000.00	\$ 90,000.00		
16	1	Ea.	For Type PW Headwall (9½'-Feet) Tall	\$53,700.00	\$ 53,700.00	\$28,000.00	\$ 28,000.00	\$45,000.00	\$ 45,000.00	\$80,000.00	\$ 80,000.00		
17	163	L.F.	For TxDOT Type C221 with Rail	\$195.00	\$ 31,785.00	\$180.00	\$ 29,340.00	\$180.00	\$ 29,340.00	\$200.00	\$ 32,600.00		
18	102	L.F.	Furnish, Install, Maintain & Remove TxDOT MBGR (Temporary Rail)	\$42.00	\$ 4,284.00	\$60.00	\$ 6,120.00	\$70.00	\$ 7,140.00	\$40.00	\$ 4,080.00		
19	0	Acre	Furnish, Install & Maintain Block Sod	\$24,750.00	\$ 8,662.50	\$25,000.00	\$ 8,750.00	\$17,000.00	\$ 5,950.00	\$20,000.00	\$ 7,000.00		
20	1	L.S.	Furnish, Install, Maintain & Remove Traffic Control Devices	\$3,000.00	\$ 3,000.00	\$25,000.00	\$ 25,000.00	\$11,500.00	\$ 11,500.00	\$10,000.00	\$ 10,000.00		
21	1	L.S.	Furnish Storm Water Pollution Prevention Plan	\$2,400.00	\$ 2,400.00	\$1,500.00	\$ 1,500.00	\$2,500.00	\$ 2,500.00	\$4,000.00	\$ 4,000.00		
22	1	L.S.	Furnish Trench Safety Plan	\$600.00	\$ 600.00	\$750.00	\$ 750.00	\$1,775.00	\$ 1,775.00	\$2,000.00	\$ 2,000.00		
23	104	L.F.	Implement Trench Safety Plan	\$2.00	\$ 208.00	\$10.00	\$ 1,040.00	\$33.00	\$ 3,432.00	\$11.00	\$ 1,144.00		
24	1	L.S.	Furnish, Install, Maintain & Remove Erosion Control Devices	\$5,500.00	\$ 5,500.00	\$10,000.00	\$ 10,000.00	\$4,000.00	\$ 4,000.00	\$10,000.00	\$ 10,000.00		
25	1	L.S.	For Supporting Existing 6-Inch Waterline and Cable TV Cable during Construction of Culvert and Headwall	\$1,800.00	\$ 1,800.00	\$1,500.00	\$ 1,500.00	\$4,000.00	\$ 4,000.00	\$1,000.00	\$ 1,000.00		
26	250	L.F.	For Replacement of 6-Inch Waterline Behind Proposed Back of Curb and Over Culvert Pipe, if required and directed by the City in Writing	\$48.00	\$ 12,000.00	\$20.00	\$ 5,000.00	\$60.00	\$ 15,000.00	\$50.00	\$ 12,500.00		
TOTAL AMOUNT BID (Items 1 Through 26)					\$ 419,726.50		\$ 424,413.50		\$ 442,495.00		\$ 569,223.00		

**RESOLUTION NO. 2015-474**

*(2015 Estate Lane Roadway Improvements Bid Award)*

**A RESOLUTION OF THE CITY COUNCIL OF THE CITY OF PARKER, COLLIN COUNTY, TEXAS, AWARDING THE CONTRACT FOR ESTATE LANE ROADWAY IMPROVEMENTS TO A&M CONSTRUCTION AND UTILITIES INC. OF ROWLETT, TEXAS.**

**WHEREAS**, the City of Parker desires to protect the health, safety and welfare of its citizens; and

**WHEREAS**, the Parker City Council, having received multiple bids for the project; deems it in the best interest of the City of Parker to approve a bid from A&M Construction and Utilities, Inc. of Rowlett, Texas to perform certain road maintenance in response to the Request for Bids for the Estate Lane Roadway Improvements in Parker, Texas;

**NOW, THEREFORE, BE IT RESOLVED BY THE CITY COUNCIL OF THE CITY OF PARKER, COLLIN COUNTY, TEXAS AS FOLLOWS:**

**SECTION 1.** The bid from A&M Construction and Utilities, Inc. of Rowlett, Texas, in the Total Amount of \$267,347.60 is approved, any non-material procedural defects in the bid are waived, and the bid specifications are in conformance with the requirements for such approval.

**SECTION 2.** The Parker City Council authorizes the Mayor to execute a contract in conformance with the approved bid, and all other necessary documents in connection therewith on behalf of the City of Parker. A copy of the contract is attached to this Resolution as Exhibit A.

**DULY RESOLVED** by the City Council of the City of Parker, Collin County, Texas on this the \_\_\_\_\_ day of \_\_\_\_\_, 2015, effective this date.

APPROVED:  
CITY OF PARKER

\_\_\_\_\_  
Z Marshall, Mayor

ATTEST:

\_\_\_\_\_  
Carrie L. Smith, City Secretary

APPROVED AS TO FORM:

---

James E. Shepherd, City Attorney

PROPOSED



**CITY COUNCIL  
FUTURE AGENDA ITEMS**

MEETING DATE	ITEM DESCRIPTION	CONTACT	Notes
<b>2015</b>			
TBD	Republic Waste Report		REQUIRED PER ORDINANCE AND AGREEMENT.
TBD	Create a comprehensive zoning ordinance review committee	Council	discussion requested 3/17
TBD	Create a Subdivision Regulations Review Committee	Council	discussion
TBD	Fire Department Building Modification	Levine	Tabled at 3/17 meeting
TBD	Discuss what materials may be transported through the City	Pettle	discussion
May 5, 2015	Solid Waste Contract		<a href="#">Allied Contract Expires 12/2015 - Termination date 10/2015</a>
June 1, 2015	Canvass May Election	City Secretary	Annual
June 1, 2015	<a href="#">Personnel Committee</a>	Council	Res. 2013-410
July 1, 2015	2015 Police Dispatch with Collin County	Police	Exp. 9/30/2015
July 1, 2015	2015 Jail Service Agreement	Police	Exp. 9/30/2015
Jan., Apr., July., Oct,	Republic Waste Report		REQUIRED PER ORDINANCE AND AGREEMENT.
July 1, 2015	<a href="#">DPS Co-op Agreement</a>	Police	Resolution 2013-422 8/31/2015
September 30, 2015	<a href="#">Review Curfew Ordinance 594</a>	Police	Reviewed and no changes made in 2012
September 30, 2015	<a href="#">2010-308 Fire and Emergency Dispatch with Plano</a>	Fire	Law requires review every five years.

**CITY COUNCIL  
FUTURE AGENDA ITEMS**

MEETING DATE	ITEM DESCRIPTION	CONTACT	Notes
September 30, 2015	<a href="#">2010-307 Fire Radio Use Agreement with Plano and Allen</a>	Fire	
October 1, 2015	Breast Cancer Awareness Month		Proclamation
November 1, 2015	Board Appointments	Ordinance	Annually in November
November 1, 2015	Diabetes Awareness Month		Proclamation